

A0

Filho  
 Rações  
 51462

<b>PREFEITURA MUNICIPAL DE ITAPIPOCA</b>					
PAVIMENTAÇÃO NAS LOCALIDADES DE MACEJÓ, JACARÉ, Córrego DA ESTRADA E APIQUES NO MUNICÍPIO DE ITAPIPOCA/CE.					
SITUAÇÃO GERAL	<table border="1"> <tr> <td>INFRAESTRUTURA</td> <td style="text-align: right;"><b>01</b></td> </tr> <tr> <td></td> <td style="text-align: right;"><b>48</b></td> </tr> </table>	INFRAESTRUTURA	<b>01</b>		<b>48</b>
INFRAESTRUTURA	<b>01</b>				
	<b>48</b>				

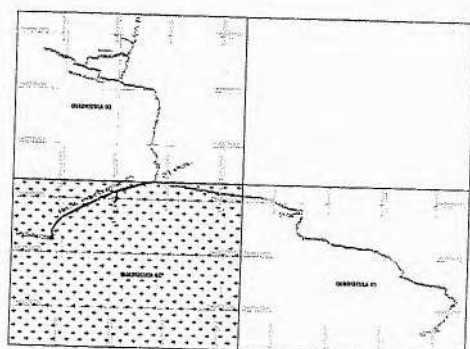
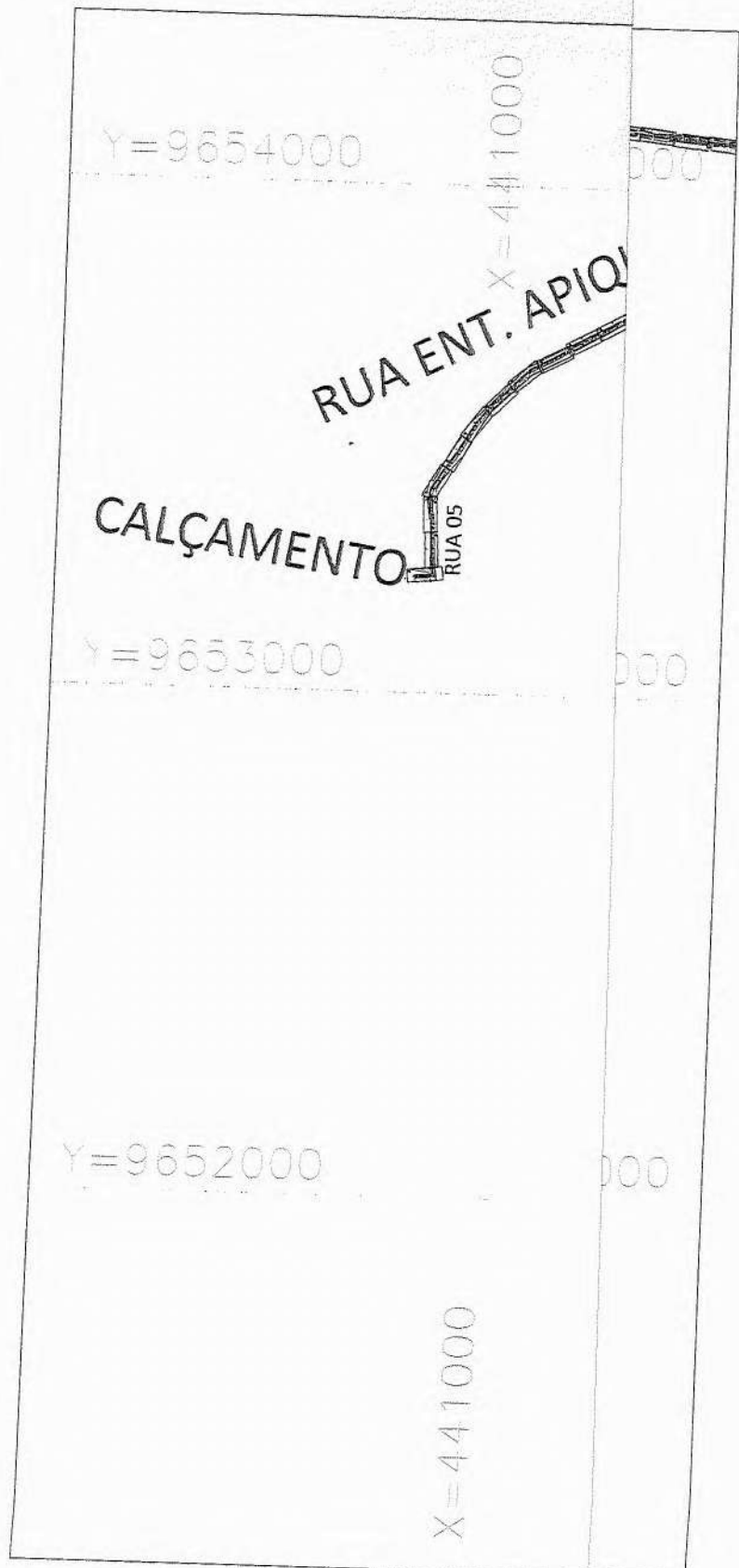

A0





PREFEITURA MUNICIPAL DE ITAIPOCA

PAVIMENTAÇÃO NAS LOCALIDADES DE MACEIÓ, JACARÉ, CÓRREGO DA ESTRADA E APIQUES NO MUNICÍPIO DE ITAIPOCA/CE.

SITUAÇÃO GERAL

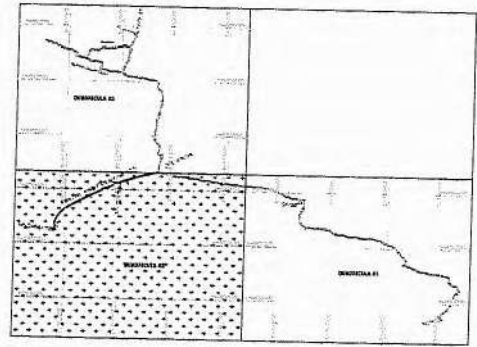
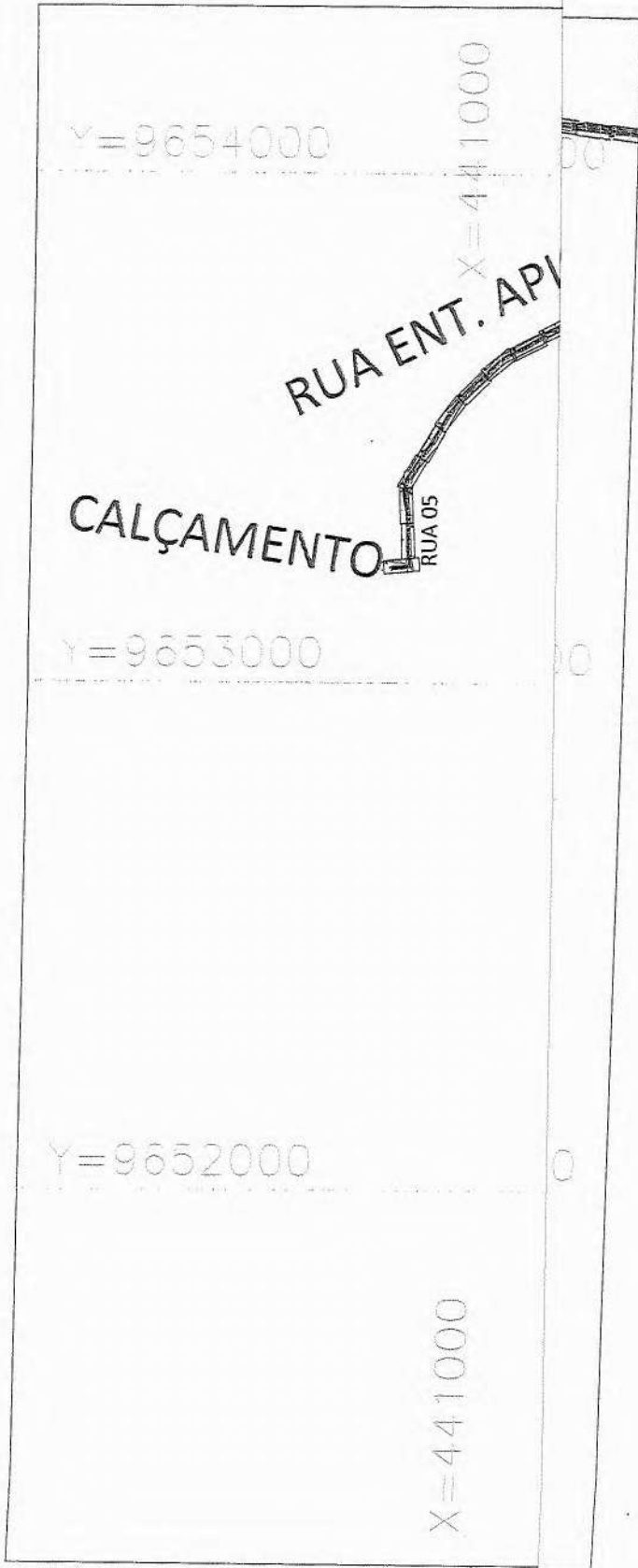
INFRAESTRUTURA **02**





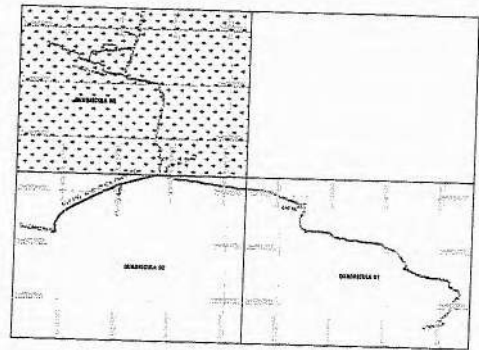
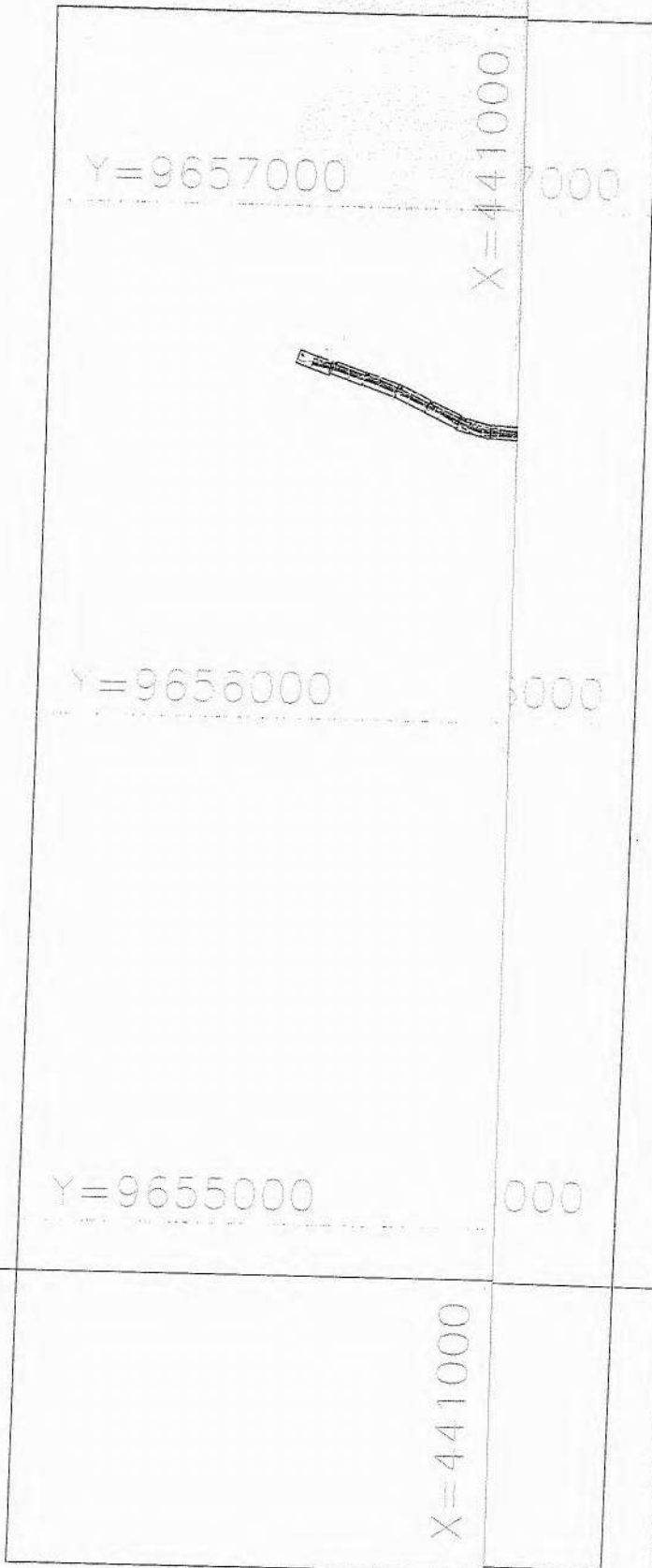

A0

<b>PREFEITURA MUNICIPAL DE ITAÍPOCA</b>	
PAVIMENTAÇÃO NAS LOCALIDADES DE MACEIÓ, JACARÉ, CÔRREGO DA ESTRADA E APIQUES NO MUNICÍPIO DE ITAÍPOCA/CE.	
SITUAÇÃO GERAL	INFRAESTRUTURA <b>02</b>

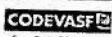

A0

lo Filho

  	
 <b>PREFEITURA MUNICIPAL DE ITAIPÓCA</b>	
PAVIMENTAÇÃO NAS LOCALIDADES DE MACEIÓ, JACARÉ, CÓRREGO DA ESTRADA E APIQUES NO MUNICÍPIO DE ITAIPÓCA/CE.	
<b>SITUAÇÃO GERAL</b>	Infraestrutura <b>03</b>

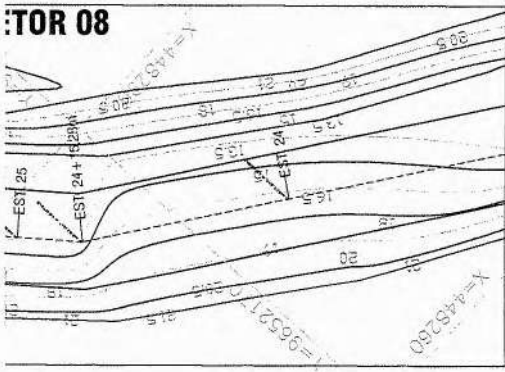
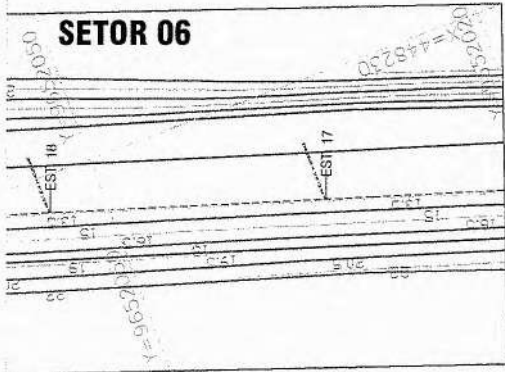
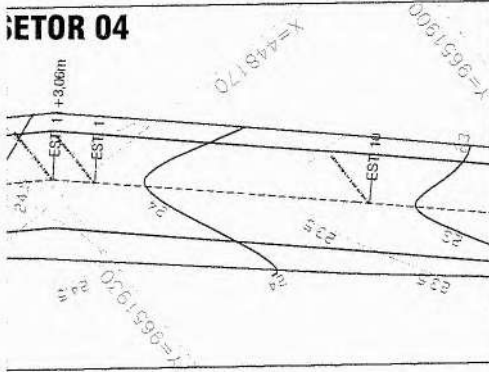
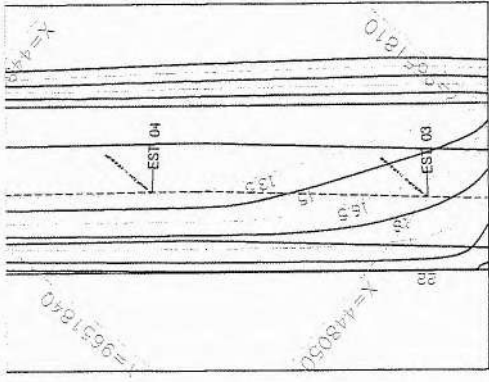

ESTACA	COORDENADAS SIRGAS 2000 - 24M
EST. 00	X= 448012,9783, Y= 9651771,2409
EST. 00 + 10,20m	X= 448022,2233, Y= 9651788,1188
EST. 01	X= 448022,6744, Y= 9651788,7304
EST. 01 + 11,70m	X= 448029,4750, Y= 9651798,3224
EST. 02	X= 448035,4854, Y= 9651804,0227
EST. 02 + 14,20m	X= 448045,6616, Y= 9651814,1811
EST. 03	X= 448050,0548, Y= 9651817,6680
EST. 04	X= 448065,5993, Y= 9651830,2675
EST. 04 + 18,20m	X= 448079,4458, Y= 9651842,3080
EST. 05	X= 448080,7449, Y= 9651843,3252
EST. 06	X= 448096,4845, Y= 9651855,6647
EST. 07	X= 448111,6209, Y= 9651868,7371
EST. 08	X= 448126,0152, Y= 9651882,6221
EST. 09	X= 448141,9155, Y= 9651898,3141
EST. 10	X= 448155,6592, Y= 9651912,8377
EST. 11	X= 448169,2801, Y= 9651927,4509
EST. 11 + 3,00m	X= 448171,3632, Y= 9651929,6874
EST. 12	X= 448180,7133, Y= 9651943,8133
EST. 12 + 4,80m	X= 448183,2512, Y= 9651947,6475
EST. 13	X= 448190,0149, Y= 9651961,4827
EST. 14	X= 448198,3731, Y= 9651978,6575
EST. 15	X= 448206,6740, Y= 9651997,8532
EST. 16	X= 448214,9758, Y= 9652016,0468
EST. 17	X= 448231,1605, Y= 9652035,0963
EST. 18	X= 448237,3214, Y= 9652054,0960
EST. 19	X= 448233,4816, Y= 9652073,1237
EST. 19 + 3,00m	X= 448234,6152, Y= 9652078,6375
EST. 20	X= 448240,8863, Y= 9652091,6904
EST. 21	X= 448248,5713, Y= 9652110,1604
EST. 22	X= 448256,2550, Y= 9652128,8224
EST. 23	X= 448263,9387, Y= 9652147,0841
EST. 23 + 1,40m	X= 448264,6440, Y= 9652148,7788
EST. 24	X= 448275,2590, Y= 9652163,5134
EST. 24 + 16,20	X= 448284,1917, Y= 9652175,9131
EST. 25	X= 448287,8868, Y= 9652178,8499
EST. 25 + 5,20m	X= 448292,0969, Y= 9652182,1962
EST. 26	X= 448304,8532, Y= 9652189,3387



LEGENDAS/NOTAS

- 01 - MEIO FIO PROJETADO
- 02 - EIXO DA VIA
- 03 - ESTAQUEAMENTO A CADA 20,00m
- 04 - SISTEMAS DE COORDENADAS (SIRGAS 2000) PROJEÇÃO UNIVERSAL TRANSVERSA MERCATOR (UTM) - ZONA - 24M
- 05 - AS MEDIDAS DE PLANTAS DEVEREM SER CONFERIDAS NO LOCAL PARA EVENTUAIS COMPENSAÇÕES

D:\H2N\ITAIPUOCA\LOGO CODEVASF.png

PREFEITURA MUNICIPAL DE ITAIPUOCA

PREPARAÇÃO PAVIMENTAÇÃO EM BLOCOS INTERTRAVADOS COM PICARRAMENTO EM VIAS NAS LOCALIDADES DE MACEIO, CÔRREGO DA ESTRADA E APIQUES

RODOVIA/APIQUES  
 SETORES 01 A 08

INFRAESTRUTURA

04  
 48

Luiz Protério Filho  
 Coord. de Obras e Edificações  
 Eng. Civil CREA-CE. 51462

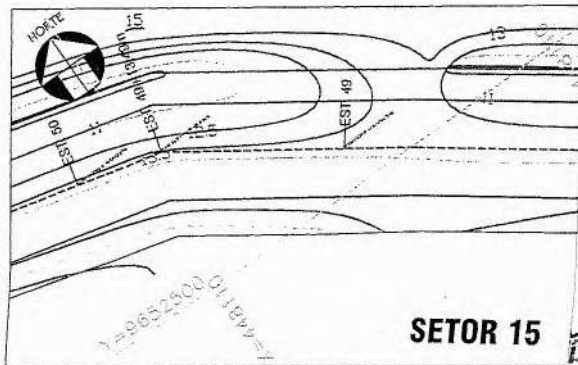
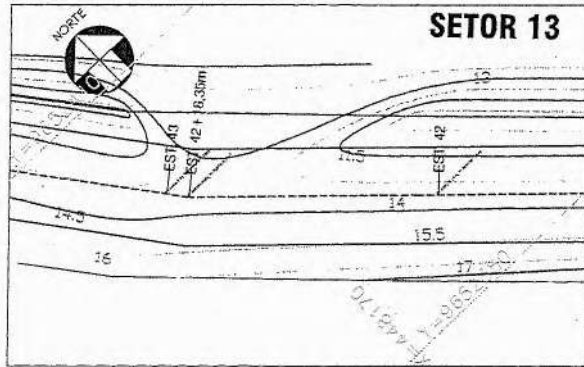
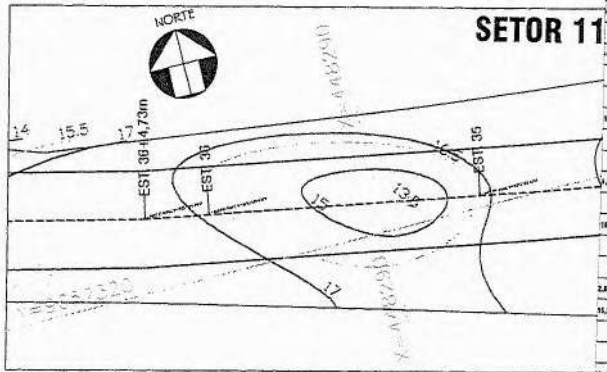
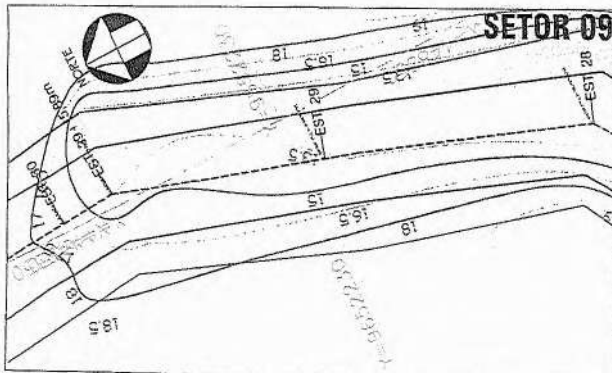

ALTIMETRIA	COORDENADAS (SIRGAS 2000 - ZONA)
X= 448522.4147, Y= 9652199.9115	
X= 448539.2755, Y= 9652209.6231	
X= 448546.0765, Y= 9652228.4301	
X= 448550.9045, Y= 9652243.5664	
X= 448550.6288, Y= 9652247.6672	
X= 448547.8701, Y= 9652267.4594	
X= 448346.0544, Y= 9652276.2894	
X= 448461.7132, Y= 9652286.3847	
X= 448341.1346, Y= 9652287.7286	
X= 448335.2684, Y= 9652298.1615	
X= 448331.3997, Y= 9652303.4716	
X= 448326.3703, Y= 9652310.3748	
X= 448316.5929, Y= 9652316.3527	
X= 448314.1246, Y= 9652317.8618	
X= 448297.2682, Y= 9652320.8156	
X= 448277.5987, Y= 9652324.4369	
X= 448272.9450, Y= 9652325.2937	
X= 448254.3048, Y= 9652328.8910	
X= 448254.1732, Y= 9652329.3592	
X= 448241.6579, Y= 9652335.9382	
X= 448239.8716, Y= 9652336.8943	
X= 448228.9440, Y= 9652344.9042	
X= 448222.8938, Y= 9652347.5058	
X= 448224.2336, Y= 9652354.0309	
X= 448207.2979, Y= 9652360.0143	
X= 448208.6092, Y= 9652363.1966	
X= 448192.6366, Y= 9652373.6136	
X= 448178.1315, Y= 9652387.3849	
X= 448164.8184, Y= 9652400.0242	
X= 448163.8259, Y= 9652401.3348	
X= 448151.4663, Y= 9652417.2188	
X= 448147.5126, Y= 9652422.6493	
X= 448148.5237, Y= 9652435.7700	
X= 448149.7774, Y= 9652451.9573	
X= 448149.8446, Y= 9652455.7187	
X= 448150.2032, Y= 9652475.7135	
X= 448150.2485, Y= 9652478.3089	
X= 448142.0942, Y= 9652488.1227	
X= 448138.3872, Y= 9652490.9107	
X= 448122.2860, Y= 9652502.7690	
X= 448111.2035, Y= 9652510.4671	
X= 448104.8942, Y= 9652512.0710	
X= 448090.9606, Y= 9652515.6132	
X= 448089.4266, Y= 9652516.5941	
X= 448073.5054, Y= 9652518.7071	
X= 448065.6480, Y= 9652519.4235	
X= 448045.7285, Y= 9652521.2395	

SEÇÃO TIPO DAS RUAS

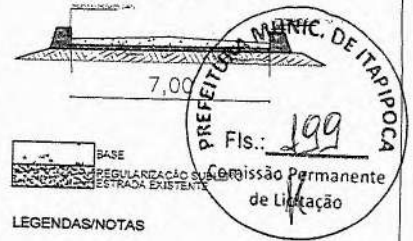

LEGENDAS/NOTAS

- 01 - MEIO FIO PROJETADO
- 02 - EIXO DA VIA
- 03 - ESTAQUEAMENTO A CADA 20,00m
- 04 - SISTEMAS DE COORDENADAS (SIRGAS 2000) PROJEÇÃO UNIVERSAL TRANSVERSA MERCATOR (UTM) -ZONA - 24M
- 05 - AS MEDIDAS DE PLANTAS DEVEM SER CONFERIDAS NO LOCAL PARA EVENTUAIS COMPENSAÇÕES



<p>PREFEITURA MUNICIPAL DE ITAIPOCA</p>	
<p>PAVIMENTAÇÃO NAS LOCALIDADES DE MACEIÓ, JACARÉ, CÔRREGO DA ESTRADA E APIQUES NO MUNICÍPIO DE ITAIPÓCA/CE.</p>	
<p>RODOVIA /APIQUES</p>	<p>INFRAESTRUTURA</p>
<p>SETORES 09 A 16</p>	<p>05</p>

Irão Filho  
e Edificações  
REA-CE. 61462

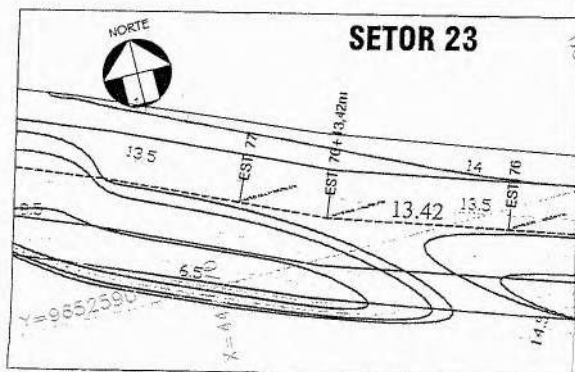
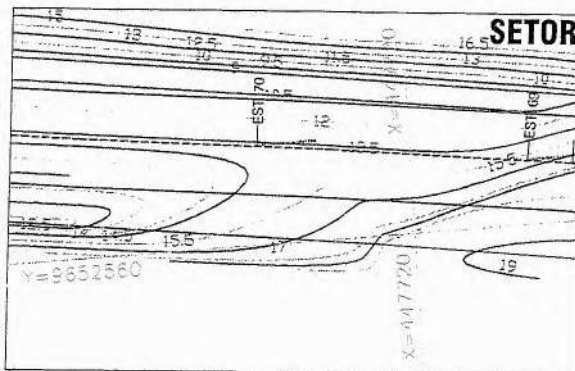
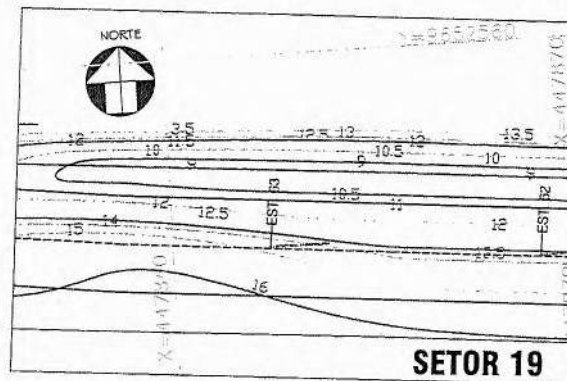
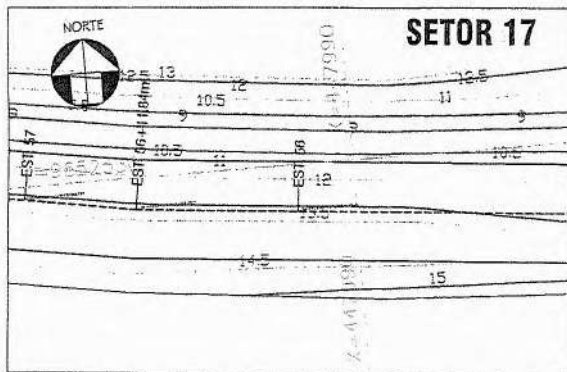

OTICAL	COORDENADAS (SIRGAS 2000 - UTM)
75,54	X= 442825,8111, Y= 9652523,0554
75,55	X= 442825,8913, Y= 9652524,4715
75,56	X= 447985,6566, Y= 9652526,7163
75,57	X= 447973,8687, Y= 9652527,7930
75,58	X= 447965,8101, Y= 9652529,0737
75,59	X= 447946,0409, Y= 9652532,2173
75,60	X= 447926,3111, Y= 9652535,3611
75,61	X= 447906,5842, Y= 9652538,5043
75,62	X= 447886,8084, Y= 9652541,6490
75,63	X= 447873,9470, Y= 9652543,3778
75,64	X= 447866,9833, Y= 9652544,1804
75,65	X= 447847,0636, Y= 9652545,9848
75,66	X= 447827,1815, Y= 9652548,0925
75,67	X= 447815,6108, Y= 9652549,5295
75,68	X= 447807,3722, Y= 9652550,8259
75,69	X= 447787,8321, Y= 9652554,0556
75,70	X= 447787,9276, Y= 9652557,4651
75,71	X= 447748,2501, Y= 9652561,0267
75,72	X= 447728,5883, Y= 9652564,6664
75,73	X= 447728,7538, Y= 9652567,2284
75,74	X= 447688,5112, Y= 9652569,7158
75,75	X= 447685,1003, Y= 9652572,4748
75,76	X= 447649,3219, Y= 9652575,4729
75,77	X= 447629,6014, Y= 9652578,8000
75,78	X= 447617,1194, Y= 9652581,2508
75,79	X= 447610,0618, Y= 9652583,0421
75,80	X= 447598,1146, Y= 9652585,0643
75,81	X= 447590,8131, Y= 9652588,5060
75,82	X= 447578,1070, Y= 9652592,7734
75,83	X= 447572,1306, Y= 9652595,5285
75,84	X= 447553,7850, Y= 9652603,4790
75,85	X= 447535,3026, Y= 9652611,1182
75,86	X= 447517,1026, Y= 9652619,4103
75,87	X= 447499,8570, Y= 9652628,0425

SEÇÃO TIPO DAS RUAS



LEGENDAS/NOTAS

- 01 - MEIO FIO PROJETADO
- 02 - EIXO DA VIA
- 03 - ESTACQUEAMENTO A CADA 20,00m
- 04 - SISTEMAS DE COORDENADAS (SIRGAS 2000) PROJEÇÃO UNIVERSAL TRANSVERSA MERCATOR (UTM)-ZONA -24M
- 05 - AS MEDIDAS DE PLANTAS DEVEREM SER CONFERIDAS NO LOCAL PARA EVENTUAIS COMPENSAÇÕES

<p><b>PREFEITURA MUNICIPAL DE ITAIPÓCA</b></p>	
<p>PAVIMENTAÇÃO NAS LOCALIDADES DE MACEIÓ, JACARÉ, CÔRREGO DA ESTRADA E APIQUES NO MUNICÍPIO DE ITAIPÓCA/CE.</p>	
<p>RODOVIA /APIQUES SETORES 17 A 24</p>	<p>06 48</p>

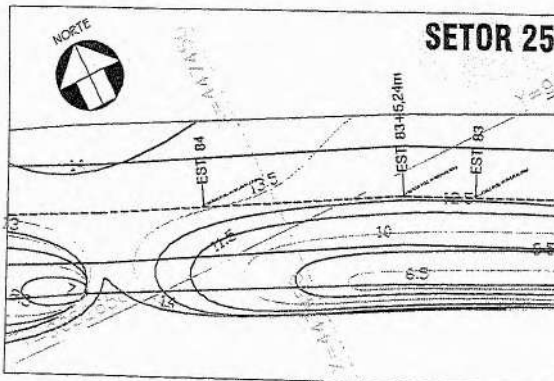

### SETOR 25

ESTACA	COORDENADAS SIRGAS 2000 - UTM
L 02	X= 447461.1626, Y= 9652636.9746
L 03	X= 447463.3605, Y= 9652646.0968
L 04 + 0,20m	X= 447458.7052, Y= 9652648.5023
L 05	X= 447445.0580, Y= 9652654.1248
L 06	X= 447426.7371, Y= 9652662.1283
L 07 + 0,870m	X= 447436.7961, Y= 9652666.6272
L 08	X= 447408.3063, Y= 9652669.8805
L 09	X= 447389.7847, Y= 9652677.4094
L 10	X= 447371.5772, Y= 9652685.6741
L 11 + 18,00m	X= 447355.0507, Y= 9652691.9978
L 12	X= 447354.6539, Y= 9652695.4443
L 13 + 14,20m	X= 447350.8939, Y= 9652709.2542
L 14	X= 447350.3881, Y= 9652714.9162
L 15 + 16,20m	X= 447348.9298, Y= 9652728.1147
L 16	X= 447348.9551, Y= 9652734.8347
L 17	X= 447349.5459, Y= 9652754.8175
L 18 + 14,00m	X= 447350.1115, Y= 9652769.4531
L 19	X= 447346.7482, Y= 9652773.6117
L 20	X= 447334.4657, Y= 9652789.3892
L 21	X= 447322.3215, Y= 9652805.2801
L 22	X= 447309.4983, Y= 9652820.9579
L 23	X= 447297.4165, Y= 9652836.5785
L 24	X= 447285.3285, Y= 9652852.4361
L 25	X= 447272.5331, Y= 9652867.8844
L 26	X= 447259.8515, Y= 9652883.3487
L 27	X= 447259.8515, Y= 9652883.3487
L 28	X= 447234.8948, Y= 9652934.6675
L 29	X= 447212.3602, Y= 9652930.4057
L 30 + 4,00m	X= 447219.5574, Y= 9652933.9841
L 31	X= 447208.9675, Y= 9652945.3712
L 32	X= 447195.6130, Y= 9652960.2586
L 33	X= 447182.0681, Y= 9652974.9710
L 34	X= 447168.4391, Y= 9652989.6685

### SEÇÃO TIPO DAS RUAS



#### LEGENDAS/NOTAS

- 01 - MEIO FIO PROJETADO \_\_\_\_\_
- 02 - EXCO DA VIA \_\_\_\_\_
- 03 - ESTAQUEAMENTO A CADA 20,00m \_\_\_\_\_
- 04 - SISTEMAS DE COORDENADAS (SIRGAS 2000) PROJEÇÃO UNIVERSAL TRANSVERSA MERCATOR (UTM) - ZONA - 24M
- 05 - AS MEDIDAS DE PLANTAS DEVEM SER CONFERIDAS NO LOCAL PARA EVENTUAIS COMPENSAÇÕES

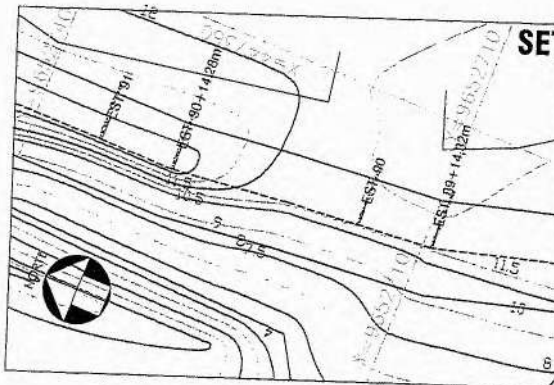

### SETOR 27

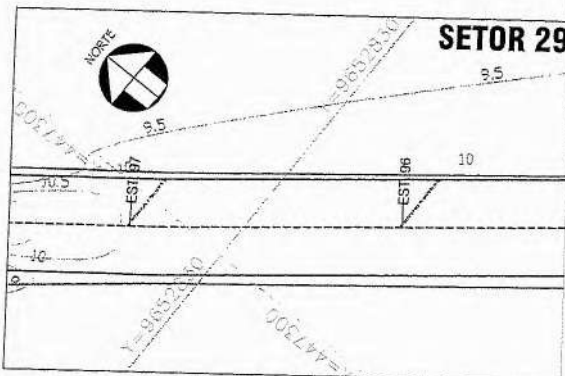

### SETOR 29

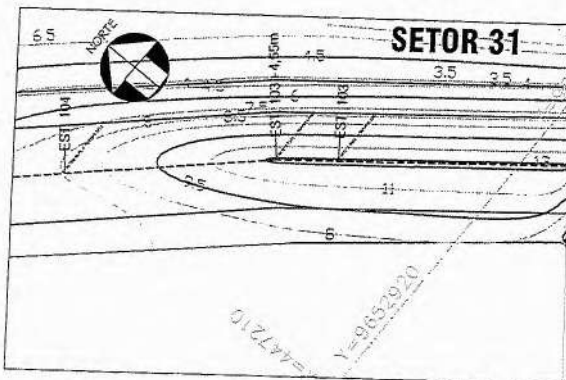

### SETOR 31

<b>PREFEITURA MUNICIPAL DE ITAIPICA</b>	
PAVIMENTAÇÃO NAS LOCALIDADES DE MACEJÓ, JACARÉ, CÔRREGO DA ESTRADA E APIQUES NO MUNICÍPIO DE ITAIPICA/CE.	
RODOVIA /APIQUES SETORES 25 A 32	07 10

o Fitto Edificações CE 51462



SEÇÃO TIPO DAS PLANTAS

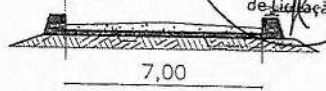

LEGENDAS/NOTAS

- 01 - MEIO FIO PROJETADO
- 02 - EXO DA VIA
- 03 - ESTADUEAMENTO A CADA 20,00m
- 04 - SISTEMAS DE COORDENADAS (SIRGAS 2000) PROJEÇÃO UNIVERSAL TRANSVERSA MERCATOR (UTM) -ZONA - 24M
- 05 - AS MEDIDAS DE PLANTAS DEVEM SER CONFERIDAS NO LOCAL PARA EVENTUAIS COMPENSAÇÕES

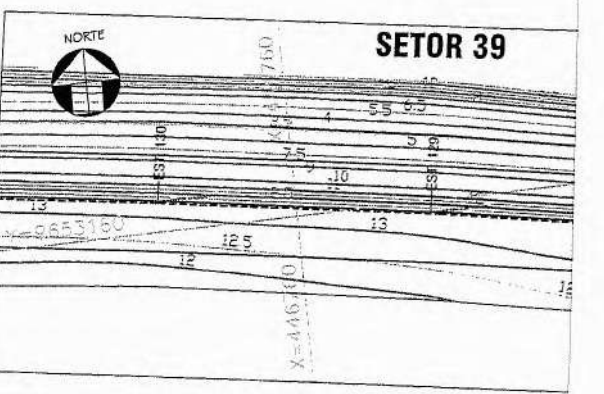
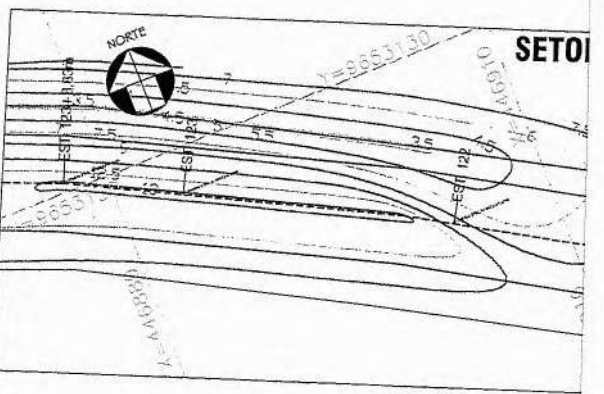
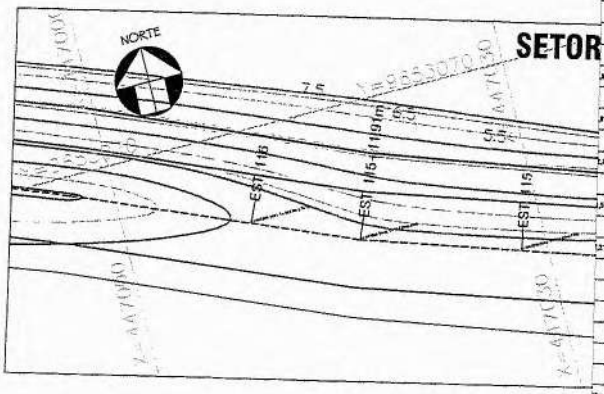
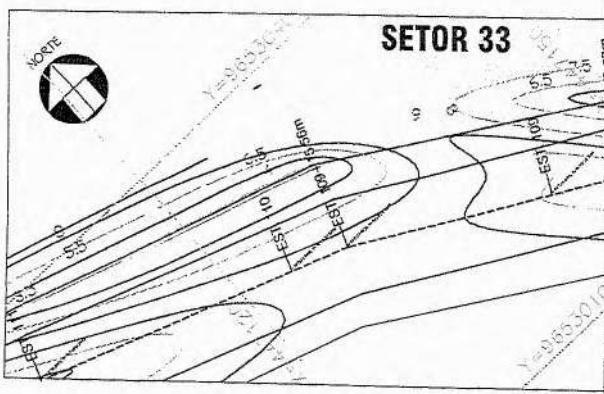

ALTI	COORDENADA (SIRGAS 2000 - 24M)
0,13m	X= 447159.3587, Y= 9652999.4355
0,13m	X= 447155.3616, Y= 9653000.7341
0,13m	X= 447147.0241, Y= 9653015.7436
0,13m	X= 447141.6089, Y= 9653018.7189
0,13m	X= 447127.9816, Y= 9653026.2198
	X= 447123.7895, Y= 9653027.6826
	X= 447104.8901, Y= 9653034.2343
	X= 447085.7100, Y= 9653039.9017
	X= 447066.4507, Y= 9653045.2877
	X= 447047.1825, Y= 9653050.6614
0,14m	X= 447037.8912, Y= 9653053.2362
	X= 447028.0593, Y= 9653056.4710
0,14m	X= 447016.7478, Y= 9653060.1903
	X= 447009.2995, Y= 9653063.3479
0,14m	X= 446990.8256, Y= 9653071.0020
	X= 446976.3005, Y= 9653076.7335
0,14m	X= 446972.3320, Y= 9653078.5871
0,14m	X= 446958.9639, Y= 9653084.8311
	X= 446954.3647, Y= 9653087.3628
	X= 446936.8634, Y= 9653097.0466
	X= 446919.4866, Y= 9653106.9473
	X= 446902.3282, Y= 9653117.2229
	X= 446884.6770, Y= 9653126.8099
0,14m	X= 446876.6343, Y= 9653130.6084
	X= 446866.5583, Y= 9653135.0472
0,14m	X= 446855.6951, Y= 9653139.6759
	X= 446847.7667, Y= 9653141.7284
0,14m	X= 446836.1435, Y= 9653144.7388
	X= 446828.3227, Y= 9653146.3755
0,14m	X= 446817.0175, Y= 9653148.7401
	X= 446808.8296, Y= 9653150.8281
0,14m	X= 446792.1569, Y= 9653155.0797
	X= 446789.4100, Y= 9653155.5584
	X= 446769.7202, Y= 9653159.0490
	X= 446749.9728, Y= 9653162.0934
	X= 446730.1538, Y= 9653164.9229
	X= 446710.2453, Y= 9653166.8071
	X= 446690.3930, Y= 9653168.5246
0,14m	X= 446684.4412, Y= 9653169.0317
	X= 446670.5321, Y= 9653170.8895

**PREFEITURA MUNICIPAL DE ITAIPÓCA**

PAVIMENTAÇÃO NAS LOCALIDADES DE MACEIÓ, JACARÉ, CÔRREGO DA  
 ESTRADA E APIQUES NO NO MUNICÍPIO DE ITAIPÓCA/CE.

RODOVIA /APIQUES  
 SETORES 33 A 40

08

SEÇÃO TIPO DAS RUAS

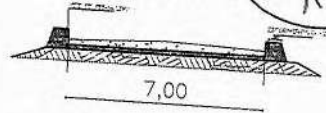

BASE  
 REGULARIZAÇÃO SUJEITO  
 ESTRADA EXISTENTE

LEGENDAS/NOTAS

- 01 - MEIO FIO PROJETADO
- 02 - EIXO DA VIA
- 03 - ESTAQUEAMENTO A CADA 20,00m
- 04 - SISTEMAS DE COORDENADAS (SIRGAS 2000) PROJEÇÃO UNIVERSAL TRANSVERSA MERCATOR (UTM)-ZONA - 24M
- 05 - AS MEDIDAS DE PLANTAS DEVEM SER CONFERIDAS NO LOCAL PARA EVENTUAIS COMPENSAÇÕES

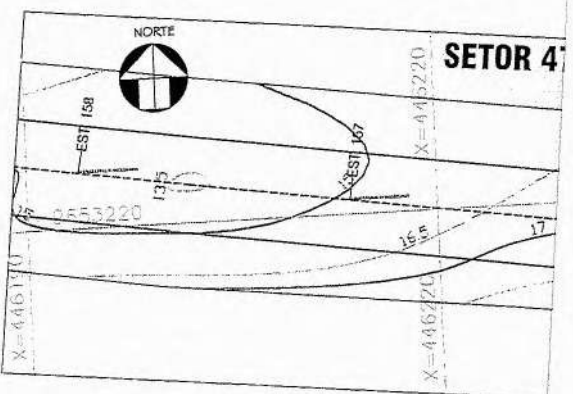
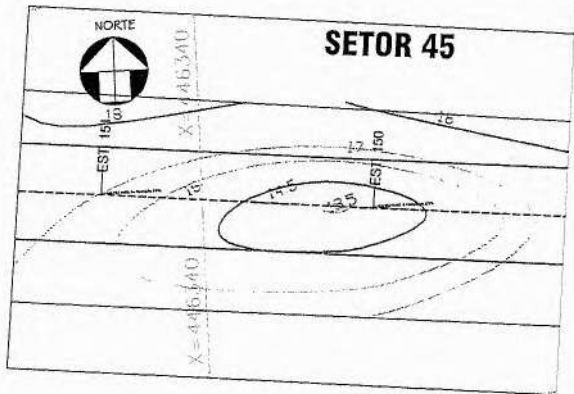
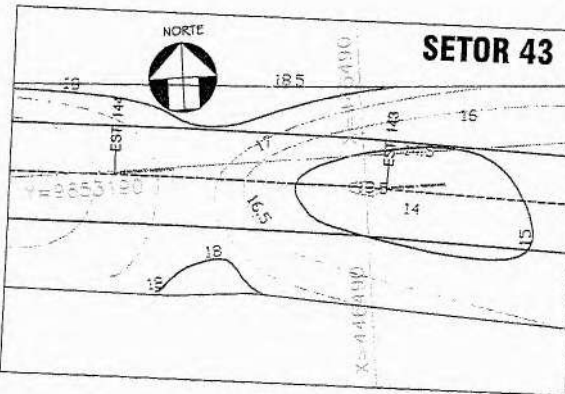
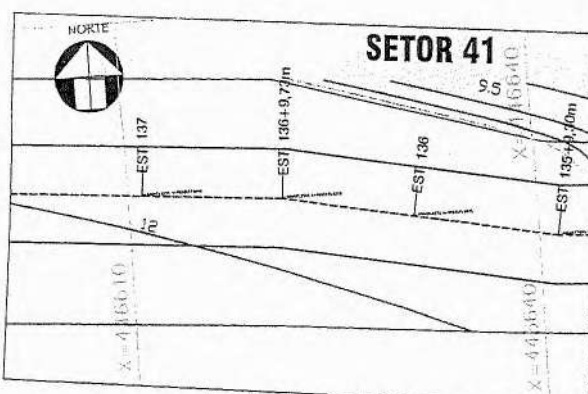

ESTACAO	SERVIDORES (PROJETO 2000 - ZONA)
134+0,00m	X= 446662,5091, Y= 9653171,9295
134+0,20m	X= 446660,6249, Y= 9653172,5499
134+0,40m	X= 446641,3305, Y= 9653173,0235
134+0,60m	X= 446630,8151, Y= 9653175,0025
134+0,80m	X= 446621,2044, Y= 9653176,8018
134+1,00m	X= 446611,0150, Y= 9653177,5948
134+1,20m	X= 446591,0663, Y= 9653178,9953
134+1,40m	X= 446571,1092, Y= 9653180,3072
134+1,60m	X= 446551,1802, Y= 9653181,7800
134+1,80m	X= 446531,2201, Y= 9653183,4600
134+2,00m	X= 446511,2743, Y= 9653184,7884
134+2,20m	X= 446491,3857, Y= 9653186,9838
134+2,40m	X= 446471,3984, Y= 9653189,7522
134+2,60m	X= 446451,7050, Y= 9653191,8243
134+2,80m	X= 446440,2022, Y= 9653193,2572
134+3,00m	X= 446431,8967, Y= 9653194,5824
134+3,20m	X= 446412,1270, Y= 9653197,5636
134+3,40m	X= 446392,2763, Y= 9653199,9969
134+3,60m	X= 446372,3903, Y= 9653202,1473
134+3,80m	X= 446352,4886, Y= 9653204,1259
134+4,00m	X= 446332,5908, Y= 9653206,1796
134+4,20m	X= 446312,6858, Y= 9653208,0927
134+4,40m	X= 446292,6873, Y= 9653208,7490
134+4,60m	X= 446272,6911, Y= 9653210,3262
134+4,80m	X= 446252,5108, Y= 9653212,7258
134+5,00m	X= 446232,3226, Y= 9653218,0926
134+5,20m	X= 446212,5460, Y= 9653221,0425
134+5,40m	X= 446192,7738, Y= 9653224,0455
134+5,60m	X= 446174,0407, Y= 9653227,1162
134+5,80m	X= 446154,0878, Y= 9653228,8725
134+6,00m	X= 446134,1608, Y= 9653230,8266
134+6,20m	X= 446112,9525, Y= 9653231,5603

Filho  
 cações

CODEVASF

INFRAESTRUTURA

PREFEITURA DE Itaipocó

PREFEITURA MUNICIPAL DE ITAIPICÓ

PAVIMENTAÇÃO NAS LOCALIDADES DE MADEJÓ, JACARÉ, CÔRREGO DA ESTRADA E APIQUES NO NO MUNICÍPIO DE ITAIPICÓ/CE.

RODOVIA /APIQUES

SETORES 41 A 48

09

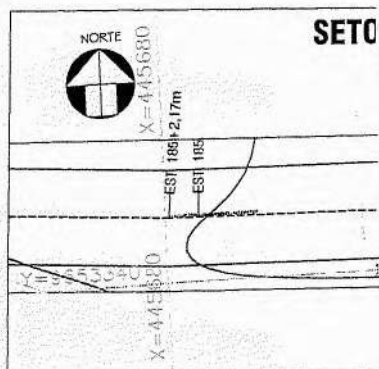
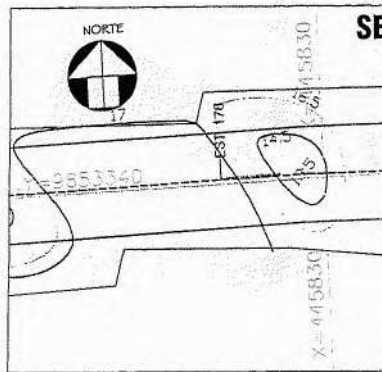
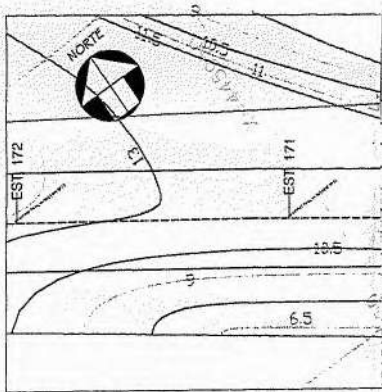
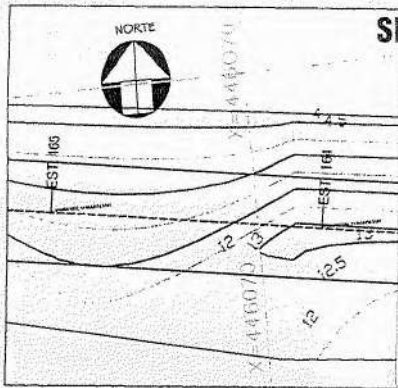

ESTACIAS	COORDENADAS SIRGAS 2000 - 2100
EST. 162	X= 446134,2864, Y= 9653232,8263
EST. 163	X= 446094,6748, Y= 9653225,5569
EST. 164	X= 446074,6954, Y= 9653238,5188
EST. 165	X= 446054,9257, Y= 9653241,5333
EST. 165+16,41m	X= 446044,5662, Y= 9653243,1159
EST. 166	X= 446035,3616, Y= 9653245,5460
EST. 167	X= 446016,0273, Y= 9653250,6252
EST. 167+12,24m	X= 446004,3469, Y= 9653253,5813
EST. 168	X= 445997,2955, Y= 9653257,2745
EST. 168+16,23m	X= 445987,9757, Y= 9653262,1558
EST. 169	X= 445980,1000, Y= 9653267,4323
EST. 170	X= 445963,5512, Y= 9653276,6699
EST. 171	X= 445947,3444, Y= 9653290,3832
EST. 172	X= 445930,9914, Y= 9653301,6023
EST. 172+9,23m	X= 445923,0049, Y= 9653307,5032
EST. 173	X= 445915,3476, Y= 9653313,8968
EST. 173+12,94m	X= 445903,5454, Y= 9653324,9648
EST. 174	X= 445899,4610, Y= 9653328,2713
EST. 174+14,32m	X= 445885,4649, Y= 9653335,0489
EST. 175	X= 445882,0226, Y= 9653339,5547
EST. 176	X= 445862,2392, Y= 9653338,4902
EST. 176+4,10m	X= 445854,1798, Y= 9653339,6861
EST. 177	X= 445842,3337, Y= 9653339,9855
EST. 178	X= 445822,3388, Y= 9653340,2927
EST. 179	X= 445802,3415, Y= 9653340,1820
EST. 180	X= 445782,3435, Y= 9653340,4638
EST. 181	X= 445762,3569, Y= 9653341,1574
EST. 182	X= 445742,3761, Y= 9653342,1489
EST. 183	X= 445722,4185, Y= 9653343,3397
EST. 184	X= 445702,4352, Y= 9653344,1581
EST. 185	X= 445682,4404, Y= 9653344,7231
EST. 185+2,17m	X= 445680,2749, Y= 9653344,7838
EST. 186	X= 445662,4968, Y= 9653346,1438
EST. 186+7,23m	X= 445655,2076, Y= 9653346,7015
EST. 187	X= 445642,5252, Y= 9653347,1392
EST. 188	X= 445622,5584, Y= 9653348,1981
EST. 189	X= 445602,6004, Y= 9653349,5512

SEÇÃO TIPO DAS RUAS



PREFEITURA MUNICIPAL DE ITAIPÓCA  
 Fis.: 204  
 Comissão Permanente de Licitação

LEGENDAS/NOTAS

- 01 - MEIO FIO PROJETADO \_\_\_\_\_
- 02 - EXDO DA VIA \_\_\_\_\_
- 03 - ESTAQUEAMENTO A CADA 20,00m \_\_\_\_\_
- 04 - SISTEMAS DE COORDENADAS (SIRGAS 2000) PROJEÇÃO UNIVERSAL TRANSVERSA MERCATOR (UTM) - ZONA - 24M
- 05 - AS MEDIDAS DE PLANTAS DEVEREM SER CONFERIDAS NO LOCAL PARA EVENTUAIS COMPENSAÇÕES

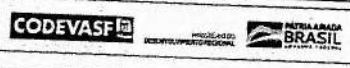
PREFEITURA DE Itaipóca  
 PREFEITURA MUNICIPAL DE ITAIPÓCA

PAVIMENTAÇÃO NAS LOCALIDADES DE MACEIÚ, JACARÉ, CÔRREGO DA ESTRADA E APIQUES NO MUNICÍPIO DE ITAIPÓCA/CE.

*[Handwritten signature]*

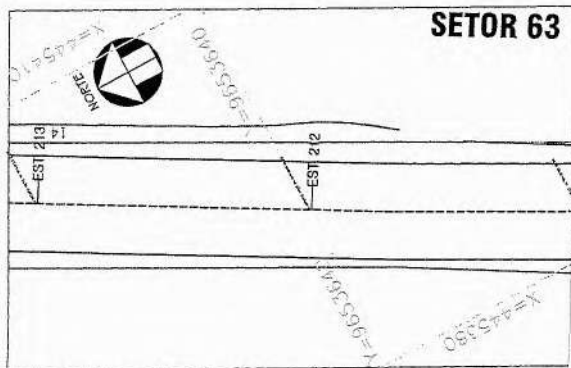
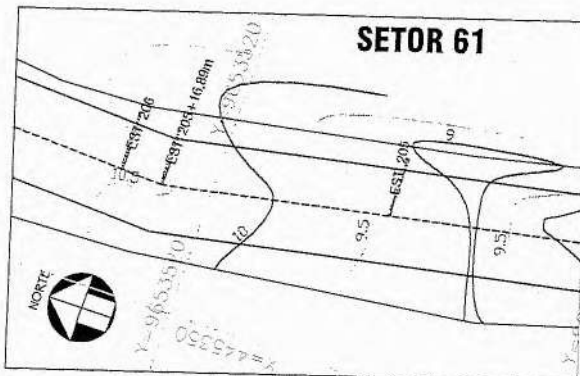
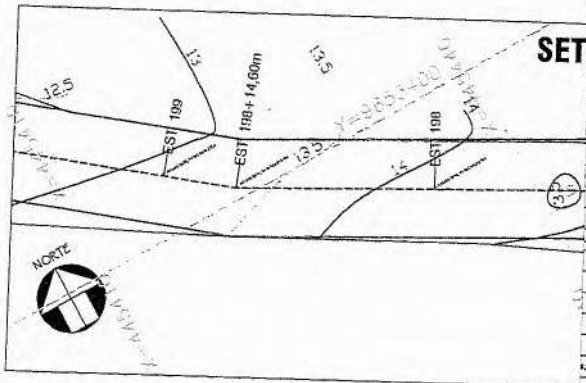
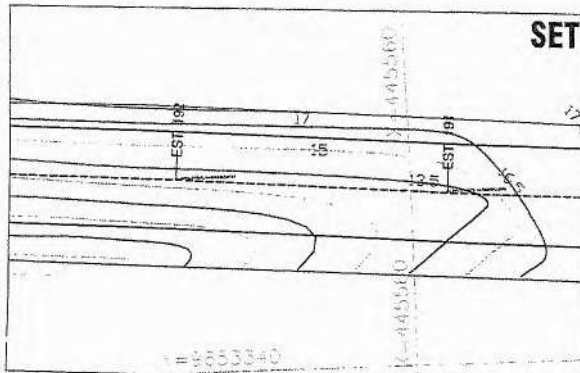

**SETOR 57**

ESTAC	COORDENADAS (SIRGAS 2000 - 24M)
	X= 445382,6481, Y= 9653350,9203
	X= 445562,4975, Y= 9653352,2901
	X= 445542,7607, Y= 9653353,8787
	X= 445522,8158, Y= 9653355,3166
	X= 445502,8621, Y= 9653356,5886
17,20m	X= 445495,6112, Y= 9653357,0277
17,20m	X= 445485,5309, Y= 9653360,0800
	X= 445483,5661, Y= 9653361,0923
14,70m	X= 445479,3306, Y= 9653363,2734
	X= 445467,1823, Y= 9653372,4791
13,60m	X= 445461,6342, Y= 9653376,6775
	X= 445450,5388, Y= 9653383,5283
	X= 445438,3093, Y= 9653393,6783
10,90m	X= 445426,5824, Y= 9653400,8396
	X= 445416,3358, Y= 9653404,1753
	X= 445400,6122, Y= 9653415,5391
	X= 445388,2939, Y= 9653432,2852
11,20m	X= 445381,7052, Y= 9653461,3703
	X= 445378,3702, Y= 9653469,4318
10,60m	X= 445372,1170, Y= 9653464,7156
	X= 445371,1368, Y= 9653468,1171
	X= 445365,5977, Y= 9653487,3348
	X= 445361,8381, Y= 9653506,9743
10,30m	X= 445358,7201, Y= 9653523,5727
	X= 445358,8304, Y= 9653526,6785
	X= 445359,9117, Y= 9653546,6519
9,70m	X= 445360,2995, Y= 9653554,1619
	X= 445362,4274, Y= 9653561,4591
9,20m	X= 445364,5729, Y= 9653578,8356
	X= 445367,0965, Y= 9653585,8332
	X= 445373,8967, Y= 9653604,6609
9,20m	X= 445375,3377, Y= 9653608,5199
	X= 445382,3612, Y= 9653622,4249
	X= 445382,7429, Y= 9653639,8664
	X= 445402,7673, Y= 9653657,1708
	X= 445413,2335, Y= 9653674,2247
	X= 445423,5061, Y= 9653691,3744
8,20m	X= 445430,0419, Y= 9653702,8994
	X= 445432,5923, Y= 9653709,1491

**SEÇÃO TIPO DAS RUAS**



**LEGENDAS/NOTAS**

- 01 - MEIO FIO PROJETADO
- 02 - EXO DA VIA
- 03 - ESTAQUEAMENTO A CADA 20,00m
- 04 - SISTEMAS DE COORDENADAS (SIRGAS 2000) PROJEÇÃO UNIVERSAL TRANSVERSA MERCATOR (UTM) -ZONA - 24M
- 05 - AS MEDIDAS DE PLANTAS DEVEM SER CONFERIDAS NO LOCAL PARA EVENTUAIS COMPENSAÇÕES

<b>PREFEITURA MUNICIPAL DE ITAÍPOCA</b>	
PAVIMENTAÇÃO NAS LOCALIDADES DE MACÊIÓ, JACARÉ, CÔRREGO DA ESTRADA E APIQUES NO NO MUNICÍPIO DE ITAÍPOCA/CE.	
RODOVIA /APIQUES SETORES 57 A 64	INFRAESTRUTURA <b>11</b>

**Irão Filho**  
 Engenharia e Edificações  
 RUA CE. 81462

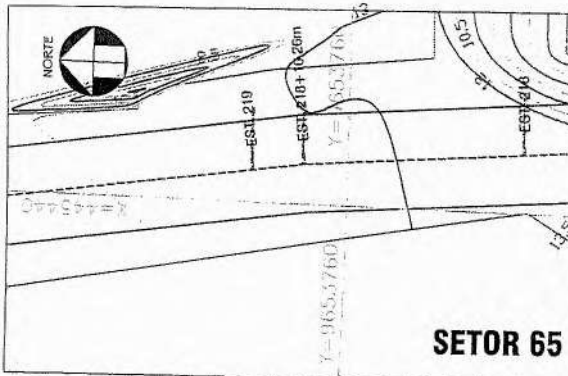

**SETOR 65**

ESTRADA	COORDENADAS (SIRGAS 2000 - 14M)
L.210+10,12m	X= 445438.8828, Y= 9653726.0732
L.217	X= 445439.8801, Y= 9653727.7645
L.217+10,27m	X= 445464.5925, Y= 9653742.2895
L.218	X= 445464.2137, Y= 9653747.0043
L.218+10,23m	X= 445442.9113, Y= 9653763.2136
L.219	X= 445442.3580, Y= 9653766.9124
L.219+10,15m	X= 445439.4815, Y= 9653786.1463
L.220	X= 445439.3243, Y= 9653786.6734
L.220+10,14m	X= 445433.7752, Y= 9653805.2770
L.221	X= 445433.6450, Y= 9653805.7659
L.222	X= 445422.2522, Y= 9653822.3406
L.223	X= 445411.0594, Y= 9653838.9153
L.224	X= 445399.8669, Y= 9653855.4896
L.224+10,20m	X= 445392.9559, Y= 9653865.7236
L.225	X= 445385.3912, Y= 9653886.3454
L.226	X= 445365.4315, Y= 9653866.3147
L.227	X= 445346.2340, Y= 9653870.2389
L.228	X= 445326.3293, Y= 9653872.1692
L.228	X= 445306.4254, Y= 9653874.1076
L.228+10,20m	X= 445305.0857, Y= 9653874.2376
L.229	X= 445287.3397, Y= 9653879.9735
L.229+0,80m	X= 445281.7466, Y= 9653881.7813
L.231	X= 445268.1345, Y= 9653885.5344
L.231+11,10m	X= 445254.4870, Y= 9653889.2972
L.232	X= 445248.7753, Y= 9653890.5144
L.233	X= 445229.2925, Y= 9653895.0054
L.234	X= 445209.8538, Y= 9653899.7206
L.235	X= 445190.3954, Y= 9653904.3468
L.236	X= 445170.9117, Y= 9653908.8608
L.236+0,70m	X= 445170.0951, Y= 9653909.0592
L.237	X= 445152.2301, Y= 9653915.8762
L.238	X= 445133.7208, Y= 9653923.5508
L.238+10,85m	X= 445123.7072, Y= 9653927.7296
L.239	X= 445115.4138, Y= 9653931.5951
L.240	X= 445097.3259, Y= 9653940.1391
L.241	X= 445079.3538, Y= 9653948.9197
L.242	X= 445061.2081, Y= 9653957.3302
L.243	X= 445043.1095, Y= 9653965.8509
L.243+0,35m	X= 445036.3791, Y= 9653969.5184
L.244	X= 445025.1981, Y= 9653974.7358

**SEÇÃO TIPO DAS RUAS**



**LEGENDAS/NOTAS**

- 01 - MIO FIO PROJETADO \_\_\_\_\_
- 02 - EIXO DA VIA \_\_\_\_\_
- 03 - ESTAQUEAMENTO A CADA 20,00m
- 04 - SISTEMAS DE COORDENADAS (SIRGAS 2000) PROJEÇÃO UNIVERSAL TRANSVERSA MERCATOR (UTM) -ZONA - 24M
- 05 - AS MEDIDAS DE PLANTAS DEVEM SER CONFERIDAS NO LOCAL PARA EVENTUAIS COMPENSAÇÕES

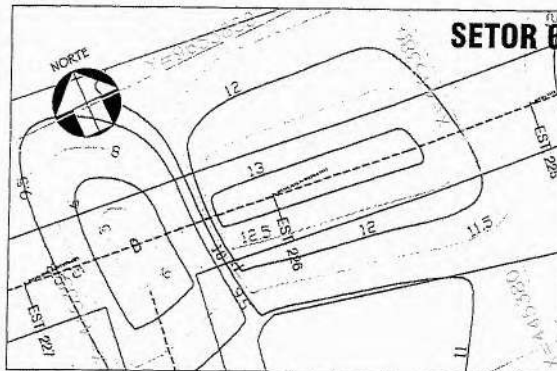

**SETOR 67**

L.231	X= 445268.1345, Y= 9653885.5344
L.231+11,10m	X= 445254.4870, Y= 9653889.2972
L.232	X= 445248.7753, Y= 9653890.5144
L.233	X= 445229.2925, Y= 9653895.0054
L.234	X= 445209.8538, Y= 9653899.7206
L.235	X= 445190.3954, Y= 9653904.3468
L.236	X= 445170.9117, Y= 9653908.8608
L.236+0,70m	X= 445170.0951, Y= 9653909.0592
L.237	X= 445152.2301, Y= 9653915.8762
L.238	X= 445133.7208, Y= 9653923.5508
L.238+10,85m	X= 445123.7072, Y= 9653927.7296
L.239	X= 445115.4138, Y= 9653931.5951
L.240	X= 445097.3259, Y= 9653940.1391
L.241	X= 445079.3538, Y= 9653948.9197
L.242	X= 445061.2081, Y= 9653957.3302
L.243	X= 445043.1095, Y= 9653965.8509
L.243+0,35m	X= 445036.3791, Y= 9653969.5184
L.244	X= 445025.1981, Y= 9653974.7358

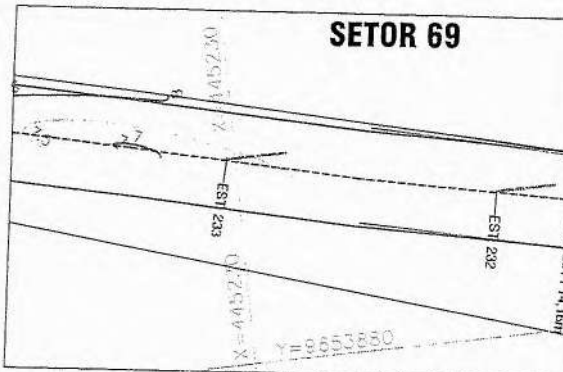

**SETOR 69**

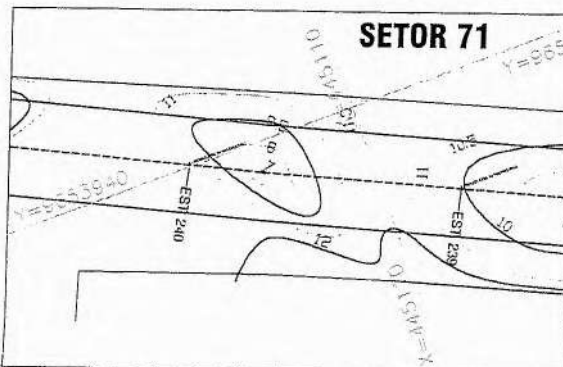

**SETOR 71**

<p><b>PREFEITURA MUNICIPAL DE ITAIPUOCA</b></p>	
<p>PAVIMENTAÇÃO NAS LOCALIDADES DE MACEIÓ, JACARÉ, CÔRREGO DA ESTRADA E APOQUES NO NO MUNICÍPIO DE ITAIPUOCA/CE.</p>	
<p>RODOVIA/APIQUES SETORES 65 A 72</p>	<p>INFRAESTRUTURA</p> <p><b>12</b></p>

**Filho**  
**as e Edificações**  
**REA-CE. 81462**

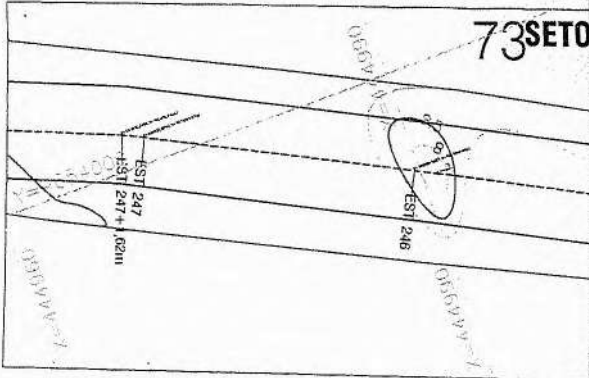

ESTACA	COORDENADAS (IRMG 2010 - 24M)
145	X= 445007.3807, Y= 9653983.8453
146	X= 444989.5637, Y= 9653992.9583
147	X= 444971.6887, Y= 9654001.8776
148+1,00m	X= 444970.2454, Y= 9654002.4023
149	X= 444953.2167, Y= 9654009.5184
150	X= 444934.6737, Y= 9654017.0023
151	X= 444916.0597, Y= 9654024.8112
152	X= 444897.3170, Y= 9654031.2861
153	X= 444878.3885, Y= 9654037.7445
154	X= 444859.6594, Y= 9654044.2420
155	X= 444840.5634, Y= 9654050.7834
156	X= 444821.6197, Y= 9654057.1844
157	X= 444802.5825, Y= 9654063.3025
158	X= 444783.2057, Y= 9654068.2559
159+1,50m	X= 444763.3879, Y= 9654068.7208
160	X= 444743.5136, Y= 9654071.0948
161+1,50m	X= 444723.7657, Y= 9654076.1138
162	X= 444703.8736, Y= 9654078.1840
163	X= 444683.9695, Y= 9654080.1203
164	X= 444664.0486, Y= 9654081.9299
165	X= 444644.1294, Y= 9654083.7761
166	X= 444624.2123, Y= 9654085.6445
167	X= 444604.3039, Y= 9654087.5385
168	X= 444584.3807, Y= 9654089.2840
169	X= 444564.4293, Y= 9654090.8707
170	X= 444544.4334, Y= 9654090.3366
171+1,00m	X= 444524.4715, Y= 9654090.2701
172	X= 444504.4715, Y= 9654091.3929
173	X= 444504.5210, Y= 9654092.7693

SEÇÃO TIPO DAS RUAS

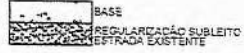
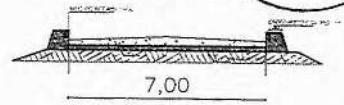

LEGENDAS/NOTAS

- 01 - MEIO RIO PROJETADO
- 02 - EIXO DA VIA
- 03 - ESTAQUEAMENTO A CADA 20,00m
- 04 - SISTEMAS DE COORDENADAS (SIRGAS 2000) PROJEÇÃO UNIVERSAL TRANSVERSA MERCATOR (UTM) - ZONA - 24M
- 05 - AS MEDIDAS DE PLANTAS DEVEM SER CONFERIDAS NO LOCAL PARA EVENTUAIS COMPENSAÇÕES

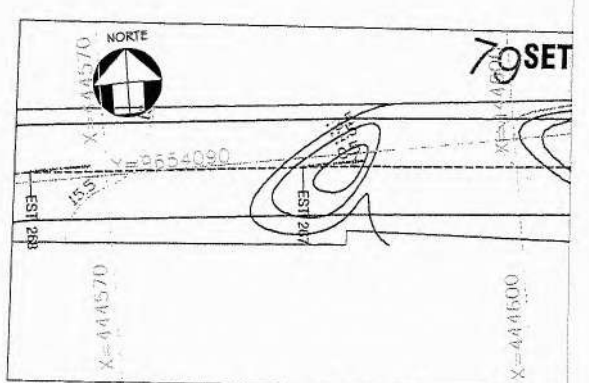
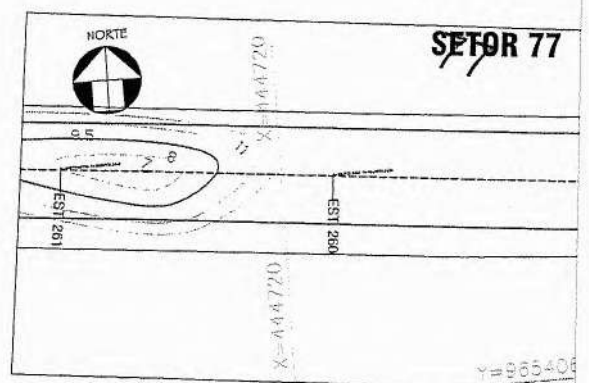
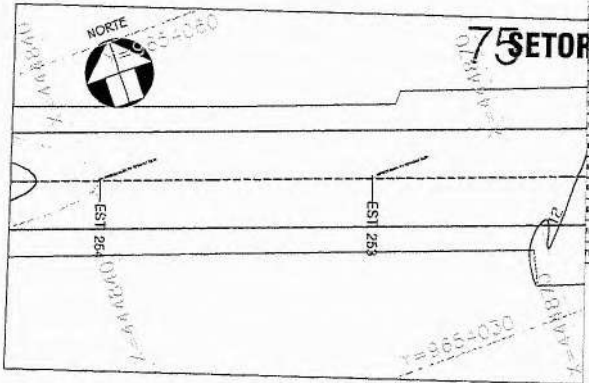

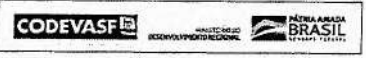
PREFEITURA DE Itaipioca  
 PREFEITURA MUNICIPAL DE ITAIPICOA

PAVIMENTAÇÃO NAS LOCALIDADES DE MACEIÓ, JACARÉ, Córrego DA ESTRADA E APIQUES NO MUNICÍPIO DE ITAIPICOA/CE.

RODOVIA /APIQUES  
 SETORES 73 A 80

INFRAESTRUTURA

ofirio Filho  
 bras e Edificações  
 CREA/CE. 51462



SEÇÃO TIPO DAS CRUMBSão Permanente de Licitação

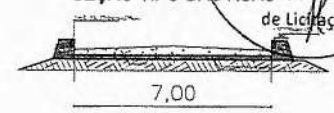

BASE  
REGULARIZAÇÃO SUBLEITO  
ESTRADA EXISTENTE

LEGENDAS/NOTAS

- 01 - MEIO FIO PROJETADO \_\_\_\_\_
- 02 - EDX DA VIA \_\_\_\_\_
- 03 - ESTAQUEAMENTO A CADA 20,00m
- 04 - SISTEMAS DE COORDENADAS (SIRGAS 2000) PROJEÇÃO UNIVERSAL TRANSVERSA MERCATOR (UTM) -ZONA - 24M
- 05 - AS MEDIDAS DE PLANTAS DEVEM SER CONFERIDAS NO LOCAL PARA EVENTUAIS COMPENSAÇÕES

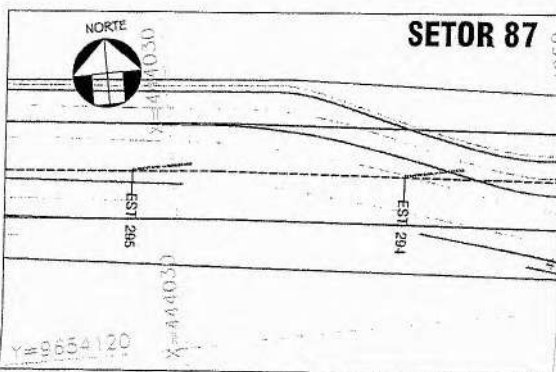
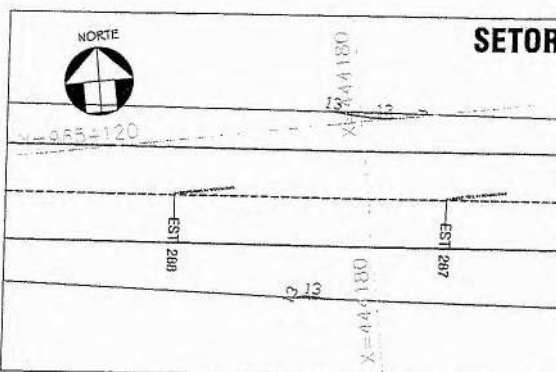
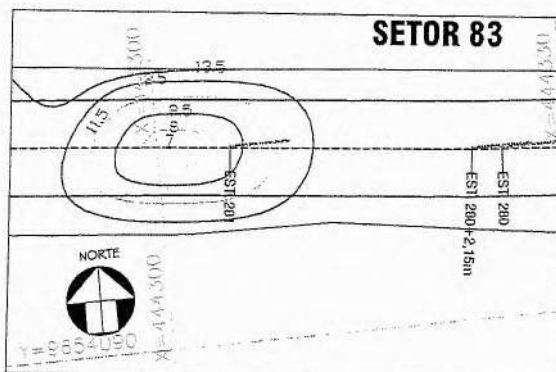
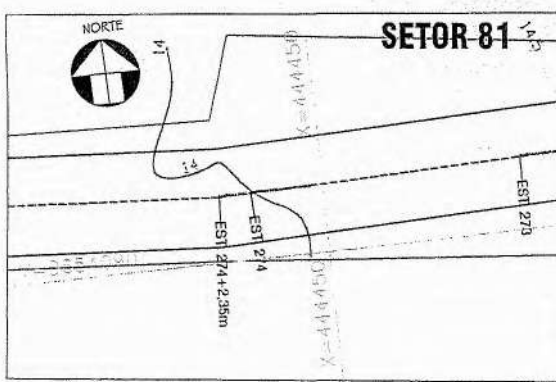

ESTACAO	COORDENADAS (SIRGAS 2000 - ZONA - 24M)
01	X= 444484.5784, Y= 9654094.2356
02+14,00m	X= 444489.7960, Y= 9654095.3633
03	X= 444484.5276, Y= 9654095.2295
04	X= 444484.6345, Y= 9654094.7115
05+2,20m	X= 444442.2842, Y= 9654094.7115
06	X= 444426.9735, Y= 9654095.7813
07+18,20m	X= 444406.7931, Y= 9654096.9684
08	X= 444403.0138, Y= 9654097.2706
09	X= 444385.0303, Y= 9654097.7473
10+12,00m	X= 444372.0404, Y= 9654098.3920
11	X= 444365.0769, Y= 9654099.0302
12	X= 444345.1504, Y= 9654100.7280
13	X= 444325.2301, Y= 9654102.2709
14+2,15m	X= 444323.0641, Y= 9654102.4372
15	X= 444305.3090, Y= 9654104.2738
16	X= 444285.3974, Y= 9654106.1201
17	X= 444265.4748, Y= 9654107.8508
18	X= 444245.5492, Y= 9654109.5172
19	X= 444225.6126, Y= 9654111.1083
20+2,70m	X= 444222.6345, Y= 9654111.3460
21	X= 444205.6310, Y= 9654111.8173
22+4,90m	X= 444200.6404, Y= 9654111.9557
23	X= 444185.7271, Y= 9654113.6543
24	X= 444165.8664, Y= 9654116.0189
25	X= 444146.0047, Y= 9654118.3409
26	X= 444126.1299, Y= 9654120.5809
27	X= 444106.1878, Y= 9654122.2271
28+2,00m	X= 444104.1512, Y= 9654122.3962
29	X= 444086.3873, Y= 9654124.9737
30	X= 444066.6299, Y= 9654128.0496
31	X= 444046.8414, Y= 9654130.9283
32	X= 444027.0933, Y= 9654133.4838
33	X= 444007.3287, Y= 9654135.6858
34	X= 443987.2529, Y= 9654137.0672
35	X= 443967.3799, Y= 9654140.1183

**PREFEITURA DE**  
**Itaipoca**  
ESTADO DO PERNAMBUCO

**PREFEITURA MUNICIPAL DE ITAIPÓCA**

PAVIMENTAÇÃO NAS LOCALIDADES DE MACEIÓ, JACARÉ, Córrego DA  
ESTRADA E APIQUES NO NO MUNICÍPIO DE ITAIPÓCA/CE.

RODOVIA /APIQUES  
SETORES 81 A 88

INFRAESTRUTURA

14

**ofirio Filho**  
ARQUITETOS

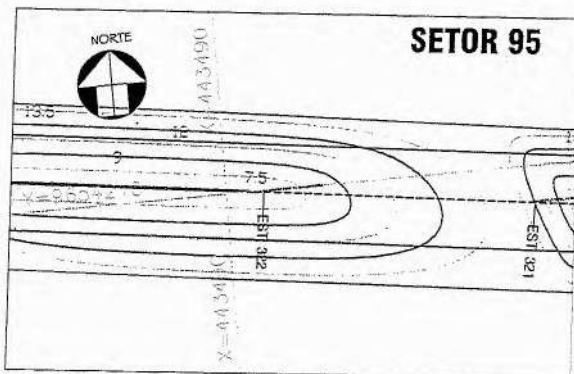
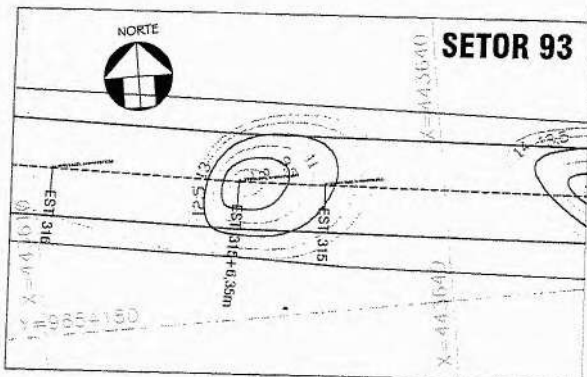
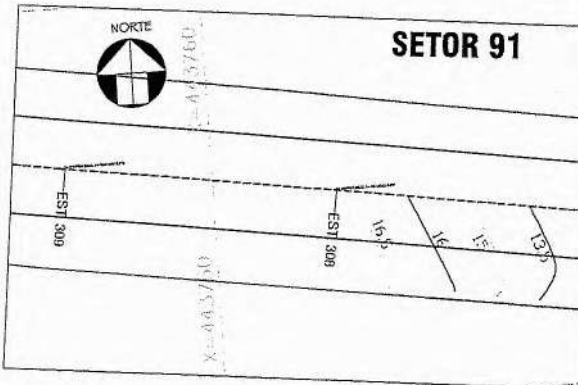
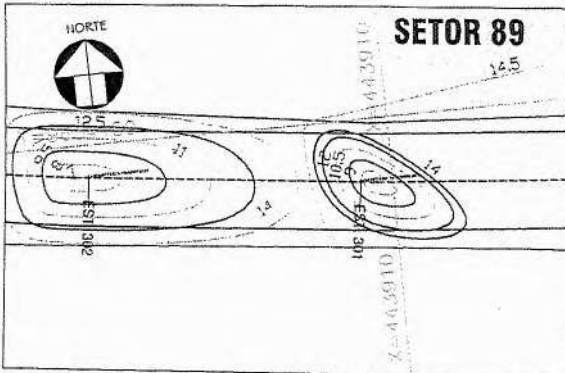

ESTRADA	COORDENADAS (SIRGAS 2000 - 24M)
323	X= 443947,4754, Y= 9654142,0211
324	X= 443927,2572, Y= 9654143,7876
321	X= 443907,8186, Y= 9654145,4377
322	X= 443687,7372, Y= 9654147,6119
323	X= 443657,2444, Y= 9654150,4522
324	X= 443648,1398, Y= 9654153,1862
325	X= 443628,3572, Y= 9654156,1001
326	X= 443808,5913, Y= 9654159,3760
327	X= 443788,8337, Y= 9654162,3112
328	X= 443769,0872, Y= 9654165,4195
329	X= 443749,3093, Y= 9654168,4258
330	X= 443720,5638, Y= 9654171,5809
331	X= 443701,0210, Y= 9654174,1041
332	X= 443679,9323, Y= 9654175,4130
333	X= 443650,3499, Y= 9654179,0777
334	X= 443670,7752, Y= 9654183,5885
335	X= 443651,0243, Y= 9654186,7327
336	X= 443631,1888, Y= 9654189,2922
337	X= 443601,8923, Y= 9654190,1047
338	X= 443611,4225, Y= 9654192,3158
339	X= 443591,0817, Y= 9654195,5082
340	X= 443571,9105, Y= 9654198,5249
341	X= 443552,1099, Y= 9654201,3649
342	X= 443532,3221, Y= 9654204,1853
343	X= 443510,0756, Y= 9654206,8085
344	X= 443512,5455, Y= 9654207,2684
345	X= 443492,7155, Y= 9654209,8704
346	X= 443472,8885, Y= 9654212,4993
347	X= 443452,9817, Y= 9654214,1337
348	X= 443452,9817, Y= 9654214,1337
349	X= 443432,9983, Y= 9654215,3030
350	X= 443424,6492, Y= 9654215,7432
351	X= 443413,0853, Y= 9654217,0717



**LEGENDAS/NOTAS**

- 01 - MEIO FIO PROJETADO \_\_\_\_\_
- 02 - EIXO DA VIA \_\_\_\_\_
- 03 - ESTAQUEAMENTO A CADA 20,00m \_\_\_\_\_
- 04 - SISTEMAS DE COORDENADAS (SIRGAS 2000) PROJEÇÃO UNIVERSAL TRANSVERSA MERCATOR (UTM) - ZONA - 24M
- 05 - AS MEDIDAS DE PLANTAS DEVEM SER CONFERIDAS NO LOCAL PARA EVENTUAIS COMPENSAÇÕES

**PREFEITURA MUNICIPAL DE ITAÍPOCA**

PAVIMENTAÇÃO NAS LOCALIDADES DE MACEIÓ, JACARÉ, CÓRREGO DA ESTRADA E APIQUES NO MUNICÍPIO DE ITAÍPOCA/CE.

RODOVIA /APIQUES

SETORES 89 A 96

INFRAESTRUTURA

15

João Filho Edificações A.C.E. 51462



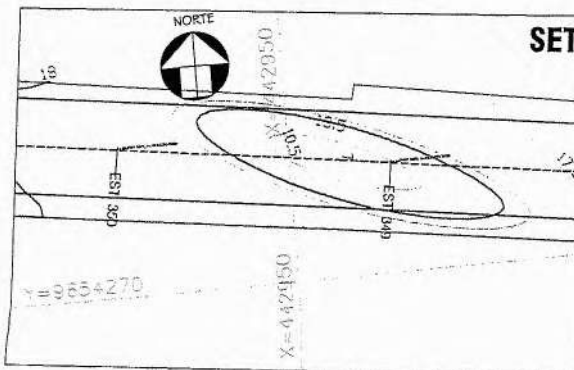
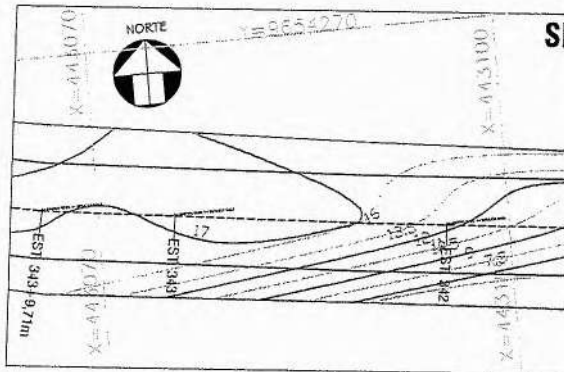
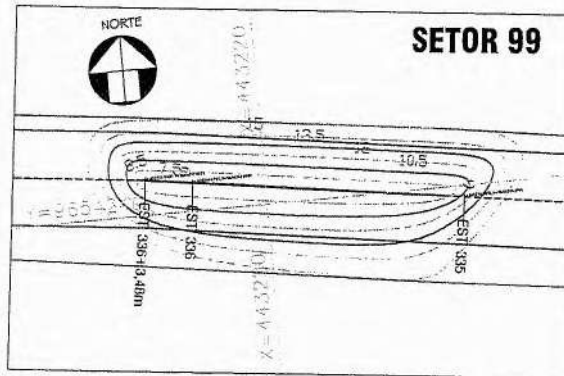
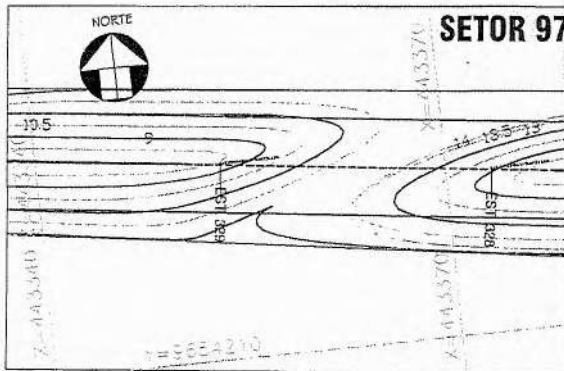

**SETOR 97**

**SETOR 99**

**SETOR 98**

**SETOR 96**

ESTACADA	SISTEMAS DE COORDENADAS (SIRGAS 2000 - UTM)
EST. 307	X= 443393.2127, Y= 9654219.3598
EST. 308	X= 443373.3466, Y= 9654221.8914
EST. 309	X= 443353.4969, Y= 9654224.1391
EST. 310	X= 443333.6472, Y= 9654226.5732
EST. 311	X= 443313.8220, Y= 9654229.2374
EST. 311+12,17m	X= 443300.7743, Y= 9654231.0220
EST. 312	X= 443283.9761, Y= 9654233.6801
EST. 313	X= 443274.0785, Y= 9654233.7081
EST. 314	X= 443254.2387, Y= 9654236.2283
EST. 315	X= 443234.4573, Y= 9654239.3745
EST. 316	X= 443214.6727, Y= 9654242.0990
EST. 316+1.48m	X= 443211.2380, Y= 9654242.6271
EST. 317	X= 443194.7929, Y= 9654244.4881
EST. 318	X= 443174.9159, Y= 9654246.4553
EST. 319	X= 443155.0108, Y= 9654248.4215
EST. 320	X= 443135.1162, Y= 9654250.4300
EST. 341	X= 443115.2394, Y= 9654252.5466
EST. 342	X= 443095.3786, Y= 9654254.9900
EST. 343	X= 443075.5438, Y= 9654257.5412
EST. 343+8,27m	X= 443065.9289, Y= 9654258.8261
EST. 344	X= 443055.8601, Y= 9654260.9717
EST. 345	X= 443036.2682, Y= 9654264.9862
EST. 346	X= 443016.6219, Y= 9654268.7030
EST. 347	X= 442996.9157, Y= 9654272.1249
EST. 348	X= 442977.1823, Y= 9654275.1564
EST. 349	X= 442957.3605, Y= 9654278.1050
EST. 350	X= 442937.5601, Y= 9654280.9306
EST. 351	X= 442917.7625, Y= 9654283.7952
EST. 352	X= 442898.0353, Y= 9654287.0702
EST. 353	X= 442878.3581, Y= 9654290.6307

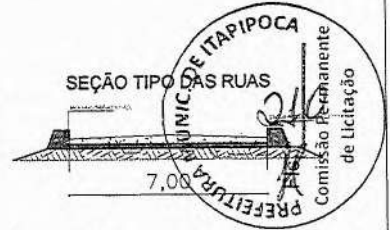

**LEGENDAS/NOTAS**

- 01 - MEIO FIO PROJETADO \_\_\_\_\_
- 02 - EIXO DA VIA \_\_\_\_\_
- 03 - ESTAQUEAMENTO A CADA 20,00m \_\_\_\_\_
- 04 - SISTEMAS DE COORDENADAS (SIRGAS 2000) PROJEÇÃO UNIVERSAL TRANSVERSA MERCATOR (UTM)-ZONA - 24M
- 05 - AS MEDIDAS DE PLANTAS DEVEM SER CONFERIDAS NO LOCAL PARA EVENTUAIS COMPENSAÇÕES

<b>PREFEITURA MUNICIPAL DE ITAIPÓCA</b>	
PAGAMENTO NAS LOCALIDADES DE MACEJÉ, JACARÉ, CÔRREGO DA ESTRADA E APIQUES NO MUNICÍPIO DE ITAIPÓCA/CE.	
RODOVIA /APIQUES SETORES 97 A 104	INFRAESTRUTURA <div style="border: 1px solid black; padding: 5px; display: inline-block;"> <b>16</b>  <b>48</b> </div>

*Ofício Filho*  
 bras e Edificações  
 54462

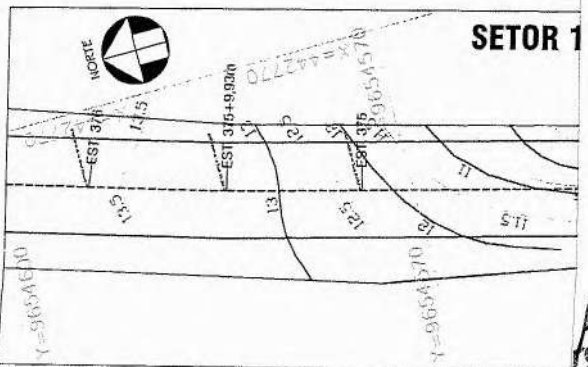
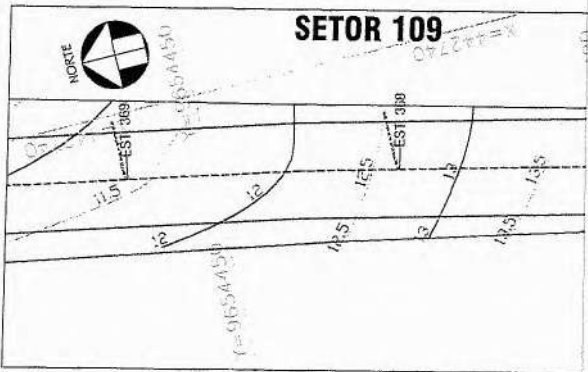
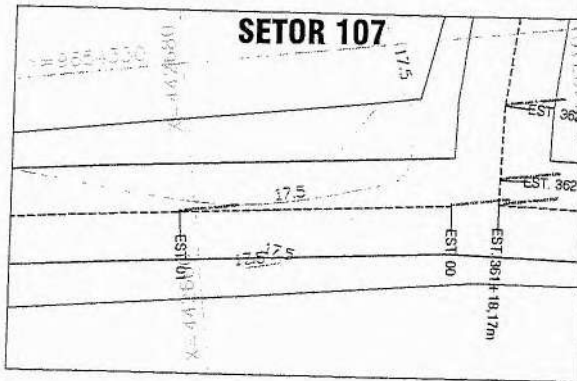
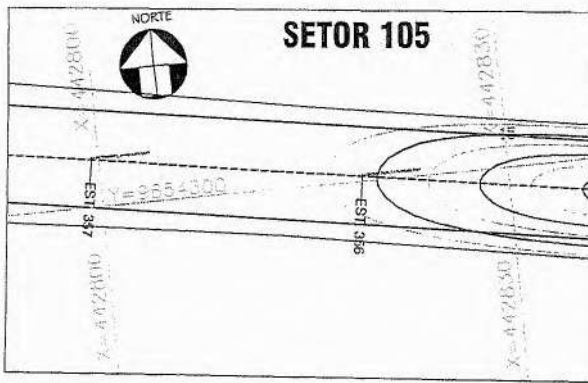

ESTADA	COORDENADAS (SIRGAS 2000 - UTM)
EST. 364	X= 442838.8472, Y= 9654294.2225
EST. 365	X= 442838.9175, Y= 9654297.2164
EST. 366	X= 442819.1621, Y= 9654300.3947
EST. 367	X= 442799.4072, Y= 9654303.5077
EST. 368	X= 442779.8182, Y= 9654306.4265
EST. 369	X= 442759.8346, Y= 9654309.2643
EST. 370	X= 442739.9909, Y= 9654311.9154
EST. 371	X= 442720.2200, Y= 9654314.9020
EST. 371+1,61m	X= 442702.2658, Y= 9654317.7107
EST. 372	X= 442702.5411, Y= 9654319.5198
EST. 372+1,02m	X= 442703.3591, Y= 9654324.8794
EST. 373	X= 442704.9696, Y= 9654328.8824
EST. 374	X= 442711.8394, Y= 9654358.2507
EST. 375	X= 442716.8083, Y= 9654377.6236
EST. 376	X= 442721.7541, Y= 9654397.6732
EST. 377	X= 442726.4216, Y= 9654417.1161
EST. 378	X= 442731.0218, Y= 9654438.5871
EST. 379	X= 442736.1410, Y= 9654456.1578
EST. 379	X= 442739.0097, Y= 9654475.7792
EST. 371	X= 442742.3020, Y= 9654495.5020
EST. 372	X= 442745.5880, Y= 9654515.2321
EST. 373	X= 442749.4112, Y= 9654534.8601
EST. 373+17,81m	X= 442753.0833, Y= 9654553.2778
EST. 374	X= 442753.4800, Y= 9654554.4000
EST. 375	X= 442758.9091, Y= 9654573.7014
EST. 376+8,87m	X= 442761.3083, Y= 9654583.2807
EST. 377	X= 442764.4960, Y= 9654592.8964
EST. 377+7,24m	X= 442766.7960, Y= 9654600.2911
EST. 377	X= 442769.8327, Y= 9654612.1728
EST. 377+7,25m	X= 442771.5468, Y= 9654619.2151
EST. 378	X= 442781.7748, Y= 9654627.4099



**LEGENDAS/NOTAS**

01 - MEIO FIO PROJETADO \_\_\_\_\_

02 - EIXO DA VIA \_\_\_\_\_

03 - ESTADUEAMENTO A CADA 20,00m

04 - SISTEMAS DE COORDENADAS (SIRGAS 2000) PROJEÇÃO UNIVERSAL TRANSVERSA MERCATOR (UTM) - ZONA - 24M

05 - AS MEDIDAS DE PLANTAS DEVEM SER CONFERIDAS NO LOCAL PARA EVENTUAIS COMPENSAÇÕES

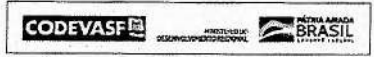
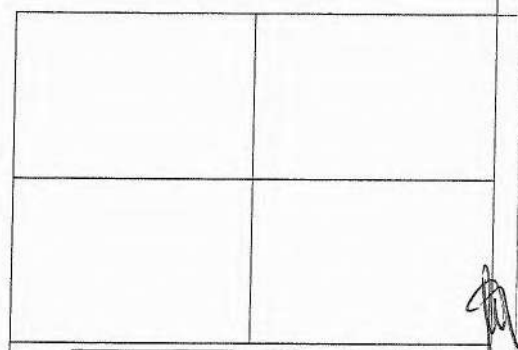

**PREFEITURA MUNICIPAL DE ITAÍPOCA**

PAVIMENTAÇÃO NAS LOCALIDADES DE MACEIÓ, JACARÉ, CÔRREGO DA ESTRADA E APIQUES NO NO MUNICÍPIO DE ITAÍPOCA/CE.

RODOVIA /APIQUES  
SETORES 105 A 112

INFRAESTRUTURA  
**17**  
**18**

*for*  
**ofício Filho**  
Obras e Edificações  
CREA-CE. 51462

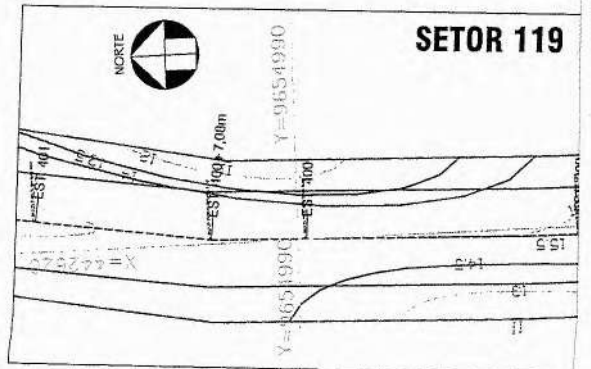
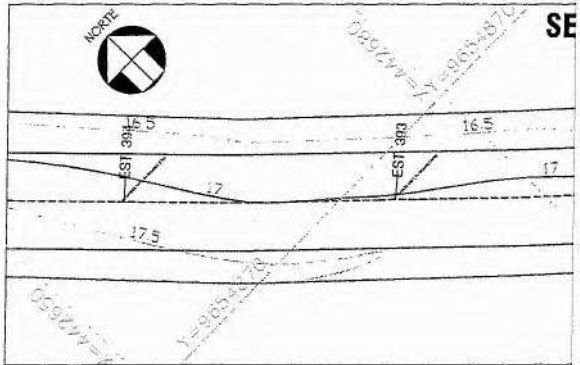
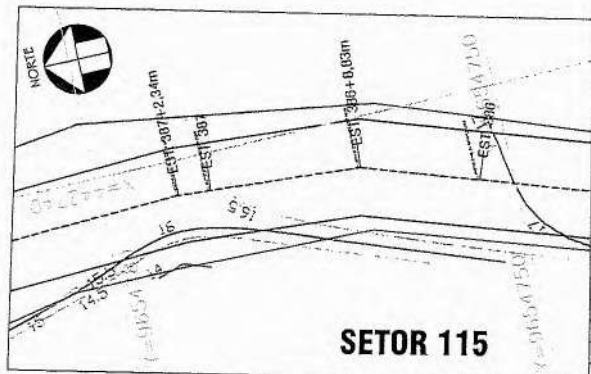
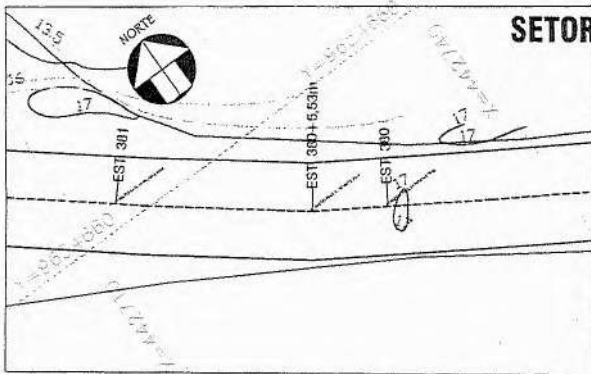

ESTACIA	COORDENADAS (SIRGAS 2000 - 24M)
EST. 378 + 10,00m	X= 442734,2070, Y= 9654634,0347
EST. 379	X= 442705,7433, Y= 9654639,2473
EST. 380	X= 442728,7645, Y= 9654649,7930
EST. 381 + 5,50m	X= 442726,0622, Y= 9654652,7313
EST. 381	X= 442712,6415, Y= 9654661,6194
EST. 381 + 16,00m	X= 442704,1887, Y= 9654668,4683
EST. 382	X= 442706,5354, Y= 9654677,2839
EST. 382 + 11,70m	X= 442709,4116, Y= 9654688,1729
EST. 383	X= 442712,4417, Y= 9654698,3602
EST. 383	X= 442718,4464, Y= 9654715,0952
EST. 383	X= 442728,8314, Y= 9654733,6845
EST. 384	X= 442733,5349, Y= 9654752,5288
EST. 384 + 6,30m	X= 442736,3703, Y= 9654760,8826
EST. 387	X= 442737,2523, Y= 9654772,0180
EST. 387 + 5,20m	X= 442737,4361, Y= 9654774,3492
EST. 387 + 18,00m	X= 442736,7721, Y= 9654790,6116
EST. 388	X= 442736,3147, Y= 9654791,9136
EST. 388 + 6,80m	X= 442733,0464, Y= 9654801,2147
EST. 388 + 19,60m	X= 442726,7551, Y= 9654809,7684
EST. 389	X= 442728,3719, Y= 9654810,1906
EST. 389	X= 442714,9361, Y= 9654820,9992
EST. 391	X= 442700,8431, Y= 9654839,2012
EST. 391	X= 442686,4843, Y= 9654853,1229
EST. 393	X= 442672,2487, Y= 9654867,0599
EST. 396	X= 442658,1474, Y= 9654881,5359
EST. 394 + 12,00m	X= 442648,8106, Y= 9654891,1926
EST. 395	X= 442644,6333, Y= 9654896,0809
EST. 395 + 11,60m	X= 442635,1433, Y= 9654908,2963
EST. 396	X= 442632,8753, Y= 9654912,2177
EST. 396 + 19,90m	X= 442624,8964, Y= 9654926,0133
EST. 397	X= 442623,6760, Y= 9654929,9556
EST. 399	X= 442619,1586, Y= 9654949,3234
EST. 399	X= 442619,3949, Y= 9654949,3720
EST. 401	X= 442620,0334, Y= 9654989,9601
EST. 408 + 7,00m	X= 442620,2910, Y= 9654996,4332
EST. 401	X= 442622,2383, Y= 9655009,2057
EST. 401 + 6,30m	X= 442623,6476, Y= 9655018,4511
EST. 402	X= 442626,2934, Y= 9655028,7672
EST. 402 + 12,30m	X= 442629,3589, Y= 9655040,7195
EST. 402	X= 442631,8815, Y= 9655047,9522
EST. 404	X= 442638,2052, Y= 9655064,2945

SEÇÃO TIPO

PREFEITURA MUNICIPAL DE ITAIPÓCA

AS RUAIS

Fis.: 242

Comissão Permanente de Licitação

7,00

- LEGENDAS/NOTAS
- 01 - MEIO FIO PROJETADO \_\_\_\_\_
- 02 - EIXO DA VIA \_\_\_\_\_
- 03 - ESTAQUEAMENTO A CADA 20,00m \_\_\_\_\_
- 04 - SISTEMAS DE COORDENADAS (SIRGAS 2000) PROJEÇÃO UNIVERSAL TRANSVERSA MERCATOR (UTM) - ZONA - 24M
- 05 - AS MEDIDAS DE PLANTAS DEVEREM SER CONFERIDAS NO LOCAL PARA EVENTUAIS COMPENSAÇÕES

CODEVASF

PREFEITURA DE Itaipoca

PREFEITURA MUNICIPAL DE ITAIPÓCA

PAVIMENTAÇÃO NAS LOCALIDADES DE MACEIÓ, JACARÉ, CÓRREGO DA ESTRADA E APIQUES NO MUNICÍPIO DE ITAIPÓCA/CE.

RODOVIA /APIQUES SETORES 113 A 120

INFRAESTRUTURA

18

18

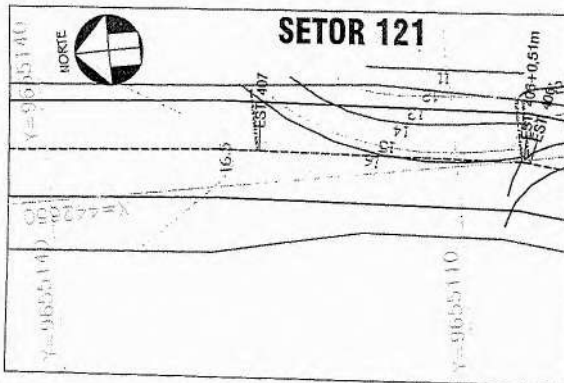

ESTACA	COORDENADAS (SIRGAS 2000 - ZONA)
000	X= 442664,3921, Y= 9655085,3076
001	X= 442669,7439, Y= 9655104,5807
002	X= 442649,8796, Y= 9655105,0729
003	X= 442652,3493, Y= 9655124,4058
004	X= 442654,5827, Y= 9655144,2307
005	X= 442654,8436, Y= 9655152,0152
006	X= 442655,0265, Y= 9655164,2838
007	X= 442655,3938, Y= 9655175,5600
008	X= 442655,8103, Y= 9655184,2643
009	X= 442656,7462, Y= 9655197,5974
010	X= 442657,4440, Y= 9655204,2010
011	X= 442659,5153, Y= 9655224,0127
012	X= 442661,9785, Y= 9655243,8633
013	X= 442664,9383, Y= 9655263,6642
014	X= 442666,8649, Y= 9655275,7362
015	X= 442669,0138, Y= 9655283,3928
016	X= 442674,6093, Y= 9655302,3967
017	X= 442680,4763, Y= 9655321,5190
018	X= 442686,8889, Y= 9655340,0250
019	X= 442692,8051, Y= 9655359,7342
020	X= 442698,0480, Y= 9655371,4655
021	X= 442698,0349, Y= 9655378,8971
022	X= 442705,1664, Y= 9655398,2249
023	X= 442708,4424, Y= 9655417,5202
024	X= 442713,4392, Y= 9655436,8881
025	X= 442716,7869, Y= 9655450,2378
026	X= 442718,4779, Y= 9655456,2381
027	X= 442723,9855, Y= 9655475,4724
028	X= 442729,3248, Y= 9655494,7410
029	X= 442731,4382, Y= 9655502,3395
030	X= 442734,2058, Y= 9655514,1290
031	X= 442736,9533, Y= 9655525,8327
032	X= 442737,9862, Y= 9655533,6952
033	X= 442740,5539, Y= 9655553,5318
034	X= 442742,4811, Y= 9655573,6607
035	X= 442742,8127, Y= 9655577,1105
036	X= 442743,6923, Y= 9655593,3967
037	X= 442744,3759, Y= 9655606,0930

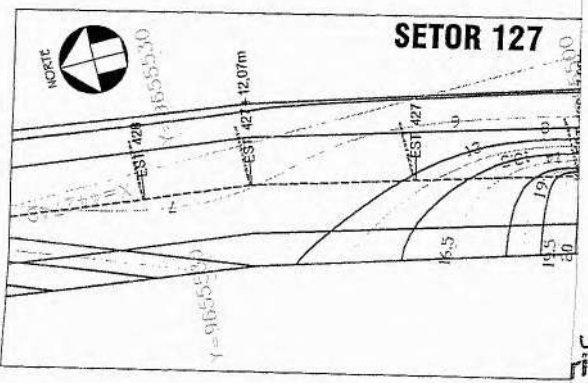
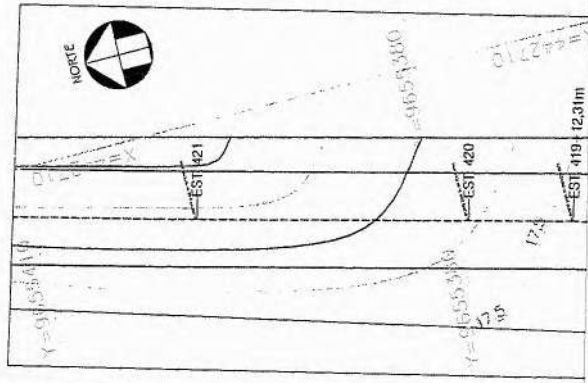
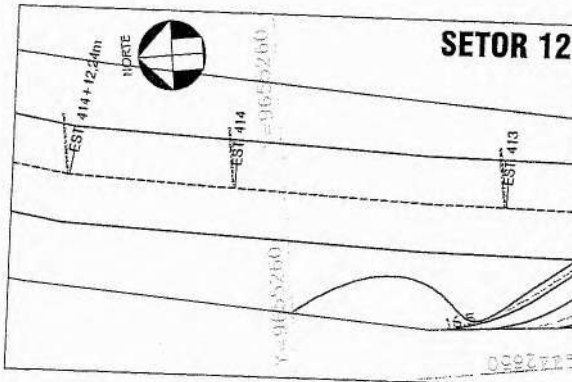

- 01 - MEIO FIO PROJETADO
- 02 - EIXO DA VIA
- 03 - ESTAQUEAMENTO A CADA 20,00m
- 04 - SISTEMAS DE COORDENADAS (SIRGAS 2000) PROJEÇÃO UNIVERSAL TRANSVERSA MERCATOR (UTM) - ZONA - 24M
- 05 - AS MEDIDAS DE PLANTAS DEVEREM SER CONFERIDAS NO LOCAL PARA EVENTUAIS COMPENSAÇÕES

D:\H2N\ITAIPUOCA\LOGO CODE VASF.png

PREFEITURA MUNICIPAL DE ITAIPUOCA

PAVIMENTAÇÃO NAS LOCALIDADES DE MACEIÓ, JACARÉ, CÔRREGO DA ESTRADA E APIQUES NO MUNICÍPIO DE ITAIPUOCA/CE.

RODOVIA /APIQUES  
 SETORES 121 A 128

INFRAESTRUTURA

19

Filho e Edificações

PREFEITURA MUNICIPAL DE ITAIPÓCA  
 Fls.: 214  
 Comissão Permanente de Licitação

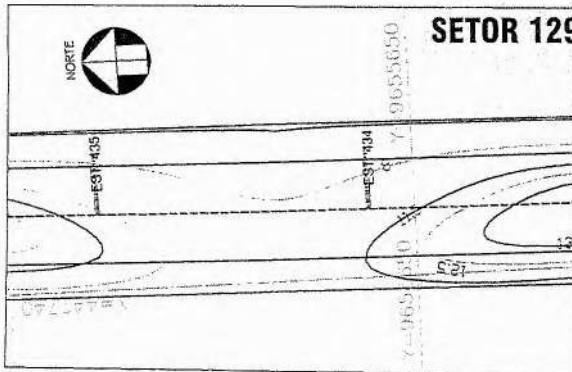

ESTRADA	COORDENADAS (SIRGAS 2000 - ZONA - 24M)
EST. 433	X= 442744.4272, Y= 9655633.3828
EST. 432	X= 442744.5673, Y= 9655633.3823
EST. 431	X= 442704.9761, Y= 9655653.3792
EST. 430	X= 442745.4999, Y= 9655678.3708
EST. 429+18,20m	X= 442745.8067, Y= 9655687.4006
EST. 428	X= 442746.2800, Y= 9655693.3502
EST. 427	X= 442747.6457, Y= 9655713.3150
EST. 426	X= 442748.4528, Y= 9655733.2871
EST. 425+9,80m	X= 442748.9021, Y= 9655742.2747
EST. 424	X= 442748.9014, Y= 9655753.2747
EST. 423+11,87m	X= 442748.9026, Y= 9655767.2644
EST. 422	X= 442748.2388, Y= 9655773.2380
EST. 421+18,85m	X= 442746.2613, Y= 9655793.1477
EST. 420	X= 442745.6254, Y= 9655793.0228
EST. 419	X= 442739.2028, Y= 9655811.9635
EST. 418+18,87m	X= 442737.3757, Y= 9655827.3515
EST. 417	X= 442725.9836, Y= 9655826.0244
EST. 416	X= 442710.2174, Y= 9655838.3088
EST. 415+19,87m	X= 442695.5850, Y= 9655850.1990
EST. 414	X= 442694.8793, Y= 9655851.0972
EST. 413	X= 442682.7430, Y= 9655866.9940
EST. 412+15,87m	X= 442681.7864, Y= 9655888.2469
EST. 411+18,20m	X= 442673.5820, Y= 9655883.8918
EST. 410	X= 442673.5090, Y= 9655884.6382
EST. 409+15,87m	X= 442673.1902, Y= 9655898.1297
EST. 408	X= 442672.8486, Y= 9655904.5962
EST. 407	X= 442675.2080, Y= 9655924.3924
EST. 406	X= 442677.9371, Y= 9655944.2098
EST. 405+15,87m	X= 442679.6322, Y= 9655956.1687
EST. 404	X= 442678.4871, Y= 9655964.0056
EST. 403+9,87m	X= 442677.2041, Y= 9655972.7878
EST. 402	X= 442671.2635, Y= 9655982.1879
EST. 401+2,87m	X= 442669.1778, Y= 9655985.4981
EST. 400	X= 442654.4244, Y= 9655991.9339
EST. 399	X= 442655.4008, Y= 9655998.0785
EST. 398	X= 442616.3066, Y= 9656004.0275
EST. 397	X= 442597.1434, Y= 9656009.7572
EST. 396+17,37m	X= 442583.8967, Y= 9656013.5756
EST. 395	X= 442577.7621, Y= 9656014.5402
EST. 394	X= 442558.0118, Y= 9656017.7051



BASE  
 REGULARIZAÇÃO SUBLEITO  
 ESTRADA EXISTENTE

LEGENDAS/NOTAS

- 01 - MEIO FIO PROJETADO \_\_\_\_\_
- 02 - EXO DA VIA \_\_\_\_\_
- 03 - ESTAQUEAMENTO A CADA 20,00m
- 04 - SISTEMAS DE COORDENADAS (SIRGAS 2000) PROJEÇÃO UNIVERSAL TRANSVERSA MERCATOR (UTM) ZONA - 24M
- 05 - AS MEDIDAS DE PLANTAS DEVEM SER CONFERIDAS NO LOCAL PARA EVENTUAIS COMPENSAÇÕES

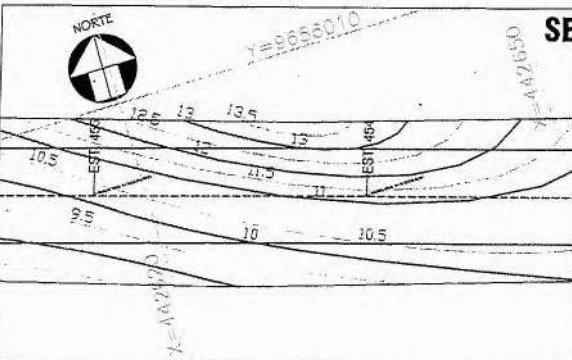
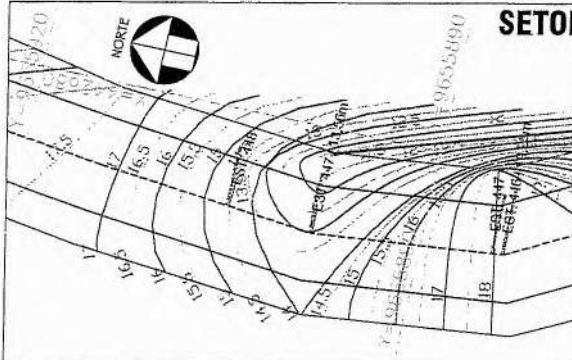
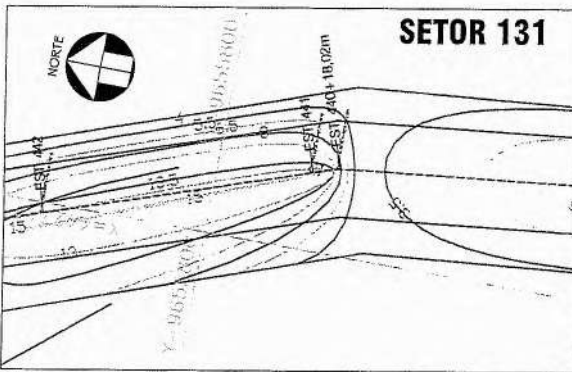

<p>PREFEITURA MUNICIPAL DE ITAIPÓCA</p>	
<p>PAVIMENTAÇÃO NAS LOCALIDADES DE MACEIÓ, JACARÉ, CÔRREGO DA ESTRADA E APIQUES NO MUNICÍPIO DE ITAIPÓCA/CE.</p>	
<p>RODOVIA/APIQUES          SETORES 129 A 136</p>	<p>INFRAESTRUTURA</p> <p style="text-align: right;"><b>20</b></p>

Arifio Filho  
 Obras e Edificações  
 51462

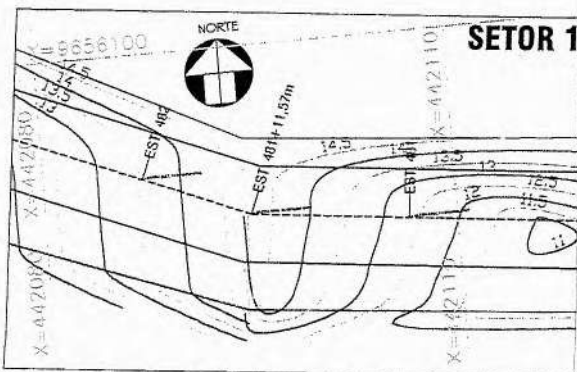
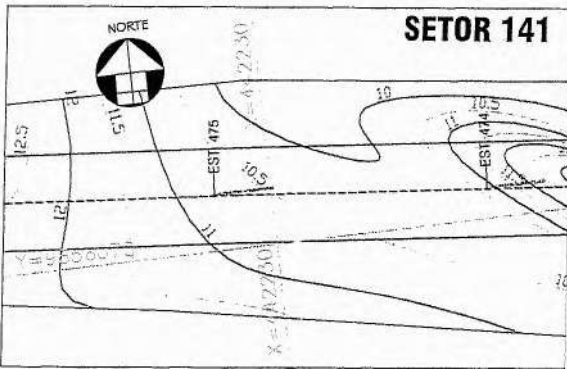
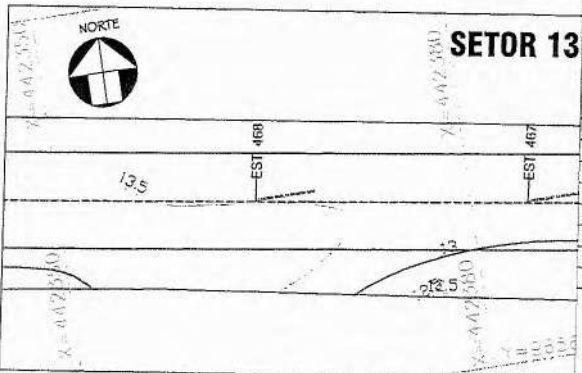
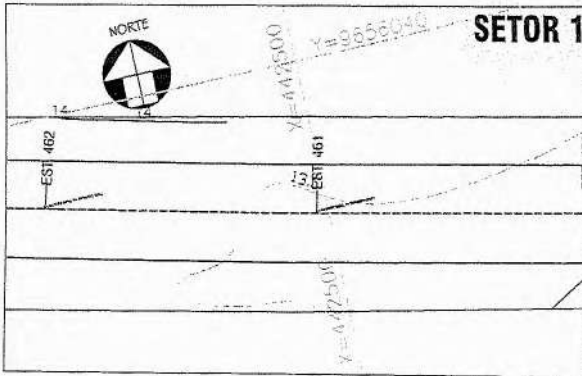

ESTADAS	COORDENADAS SIRGAS 2000 - UTM
EST. 459	X= 442536.3028, Y= 9656021.0901
EST. 461	X= 442518.6311, Y= 9656028.6989
EST. 461	X= 442499.1022, Y= 9656029.0101
EST. 462	X= 442479.8496, Y= 9656033.9631
EST. 463	X= 442462.8570, Y= 9656037.2791
EST. 464	X= 442443.2426, Y= 9656041.1687
EST. 465	X= 442423.5584, Y= 9656044.7444
EST. 466	X= 442403.8884, Y= 9656048.3074
EST. 467	X= 442384.1432, Y= 9656051.4770
EST. 468	X= 442364.3808, Y= 9656054.5697
EST. 469	X= 442344.6240, Y= 9656057.6969
EST. 470	X= 442324.8547, Y= 9656060.7188
EST. 471	X= 442305.0443, Y= 9656063.4802
EST. 472	X= 442285.2845, Y= 9656066.5782
EST. 473	X= 442265.5140, Y= 9656069.6362
EST. 473+10.70m	X= 442254.9093, Y= 9656071.2750
EST. 474	X= 442245.6818, Y= 9656073.1612
EST. 475	X= 442225.7708, Y= 9656074.0511
EST. 476	X= 442205.8403, Y= 9656075.7164
EST. 477	X= 442185.9547, Y= 9656077.8943
EST. 478	X= 442166.1392, Y= 9656080.6155
EST. 478+0.20m	X= 442160.5196, Y= 9656081.0185
EST. 479	X= 442146.2195, Y= 9656082.1678
EST. 479+0.20m	X= 442139.3385, Y= 9656082.5303
EST. 480	X= 442126.3912, Y= 9656084.0006
EST. 481	X= 442106.4391, Y= 9656085.2747
EST. 481+11.87m	X= 442094.5498, Y= 9656087.8074
EST. 482	X= 442087.1657, Y= 9656090.8436
EST. 482+14.20m	X= 442073.7543, Y= 9656096.4194
EST. 483	X= 442069.2086, Y= 9656099.1597
EST. 483+14.77m	X= 442054.4862, Y= 9656107.5453
EST. 484	X= 442052.4326, Y= 9656110.0384
EST. 485	X= 442039.7169, Y= 9656125.4757

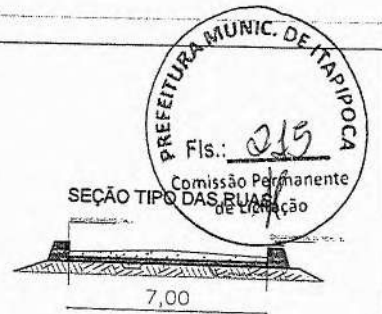

BASE  
REGULARIZAÇÃO SUBLEITO  
ESTRADA EXISTENTE

LEGENDAS/NOTAS

- 01 - MEIO FIO PROJETADO \_\_\_\_\_
- 02 - EXO DA VIA \_\_\_\_\_
- 03 - ESTAQUEAMENTO A CADA 20,00m \_\_\_\_\_
- 04 - SISTEMAS DE COORDENADAS (SIRGAS 2000) PROJEÇÃO UNIVERSAL TRANSVERSA MERCATOR (UTM) - ZONA - 24M
- 05 - AS MEDIDAS DE PLANTAS DEVEM SER CONFERIDAS NO LOCAL PARA EVENTUAIS COMPENSAÇÕES

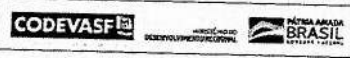
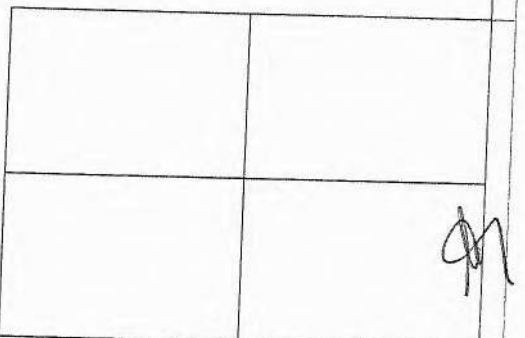

PREFEITURA DE Itaipioca  
PREFEITURA MUNICIPAL DE ITAÍPOICA

PAVIMENTAÇÃO NAS LOCALIDADES DE MACEIÓ, JACARÉ, CÔRREGO DA ESTRADA E APIQUES NO MUNICÍPIO DE ITAÍPOICA/CE.

RODOVIA/APIQUES  
SETORES 137 A 144

INFRAESTRUTURA

Filho  
as e Edificações  
DE 51452

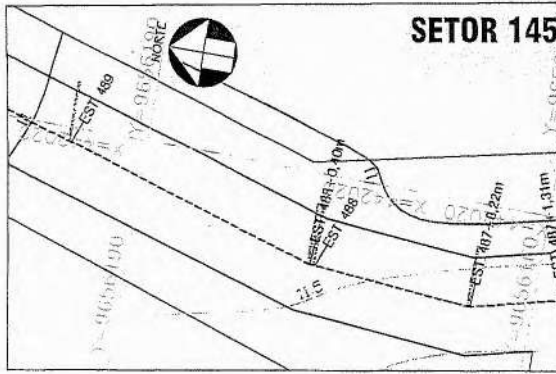

**SETOR 145**

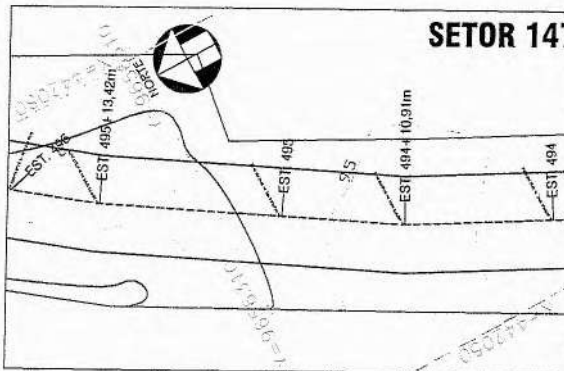

**SETOR 147**

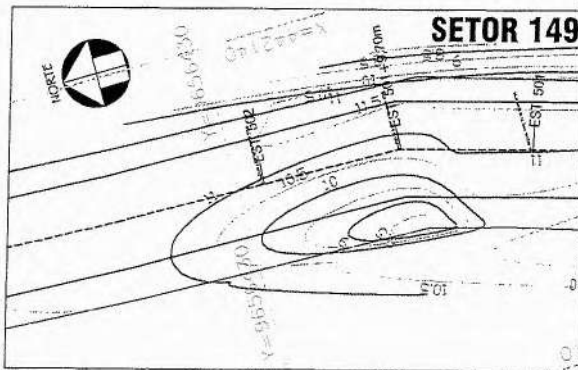

**SETOR 149**

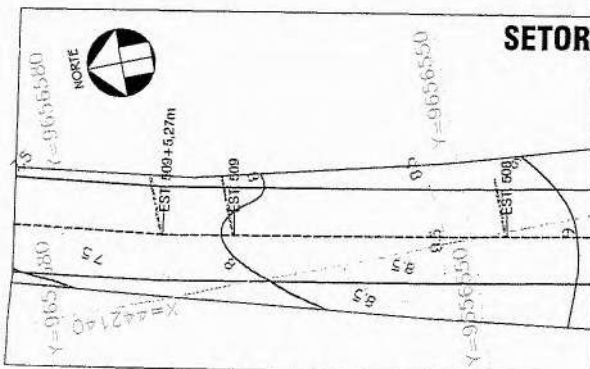

**SETOR**

ESTACA	COORDENADAS (SIRGAS 2000 - 2100)
ST. 486	X= 442077.1273, Y= 9656141.0119
ST. 487	X= 442014.9577, Y= 9656156.8723
ST. 487+1,20m	X= 442014.1892, Y= 9656157.9274
ST. 487+4,20m	X= 442012.5026, Y= 9656164.0293
ST. 488	X= 442013.3883, Y= 9656176.3760
ST. 488+0,40m	X= 442013.4181, Y= 9656176.7709
ST. 488	X= 442013.9241, Y= 9656195.5816
ST. 488	X= 442025.2176, Y= 9656216.5672
ST. 488+1,20m	X= 442027.5433, Y= 9656221.3834
ST. 491	X= 442051.2063, Y= 9656233.6480
ST. 491+10,37m	X= 442034.3648, Y= 9656244.1502
ST. 492	X= 442037.9613, Y= 9656252.4303
ST. 492	X= 442045.9713, Y= 9656270.7562
ST. 492+3,30m	X= 442047.9950, Y= 9656275.3850
ST. 494	X= 442054.7986, Y= 9656288.6982
ST. 494+10,37m	X= 442059.7657, Y= 9656298.4171
ST. 499	X= 442064.6780, Y= 9656306.0054
ST. 499+12,42m	X= 442071.9293, Y= 9656317.3557
ST. 499	X= 442075.9519, Y= 9656322.5629
ST. 499+10,37m	X= 442085.5279, Y= 9656334.9591
ST. 499	X= 442087.9585, Y= 9656338.6081
ST. 499	X= 442099.0136, Y= 9656355.2854
ST. 499	X= 442109.5980, Y= 9656372.2553
ST. 499+4,50m	X= 442112.0637, Y= 9656376.2088
ST. 500	X= 442119.1645, Y= 9656389.8263
ST. 500+7,10m	X= 442122.4792, Y= 9656396.1538
ST. 501	X= 442126.0991, Y= 9656408.4729
ST. 501+9,70m	X= 442128.8137, Y= 9656417.7793
ST. 502	X= 442129.1208, Y= 9656428.0753
ST. 502	X= 442129.9002, Y= 9656448.0569
ST. 502+12,40m	X= 442130.5521, Y= 9656460.4972
ST. 504	X= 442131.4115, Y= 9656467.5881
ST. 504+16,30m	X= 442131.2527, Y= 9656484.0353
ST. 508	X= 442133.5227, Y= 9656487.8736
ST. 508	X= 442134.9007, Y= 9656507.8256
ST. 507	X= 442136.0063, Y= 9656527.7951
ST. 507+1,87m	X= 442136.1150, Y= 9656529.7575
ST. 508	X= 442139.6159, Y= 9656547.4664
ST. 509	X= 442143.6688, Y= 9656567.2264
ST. 509+4,27m	X= 442144.7536, Y= 9656572.1811
ST. 510	X= 442148.6359, Y= 9656586.3902
ST. 510+10,30m	X= 442152.0486, Y= 9656598.8803
ST. 511	X= 442153.6260, Y= 9656605.7518
ST. 512	X= 442158.1009, Y= 9656625.2448
ST. 513	X= 442162.6785, Y= 9656644.7136



- LEGENDAS/NOTAS**
- 01 - MEIO FIO PROJETADO
  - 02 - EIXO DA VIA
  - 03 - ESTRAQUEAMENTO A CADA 20,00m
  - 04 - SISTEMAS DE COORDENADAS (SIRGAS 2000) PROJEÇÃO UNIVERSAL TRANSVERSA MERCATOR (UTM)-ZONA - 24M
  - 05 - AS MEDIDAS DE PLANTAS DEVEM SER CONFERIDAS NO LOCAL PARA EVENTUAIS COMPENSAÇÕES

**PREFEITURA MUNICIPAL DE ITAIPÓCA**

PAVIMENTAÇÃO NAS LOCALIDADES DE MACEIÓ, JACARÉ, CÔRREGO DA ESTRADA E APIQUES NO NO MUNICÍPIO DE ITAIPÓCA/CE.

RODOVIA/APIQUES  
SETORES 145 A 152

INFRAESTRUTURA

22

*Profirio Filho*  
de Obras e Edificações  
RUA CE. 51482



SEÇÃO TIPO DAS RUAS

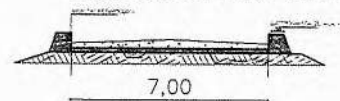

LEGENDAS/NOTAS

01 - MEIO FIO PROJETADO \_\_\_\_\_

02 - EXO DA VIA \_\_\_\_\_

03 - ESTRAQUEAMENTO A CADA 20,00m

04 - SISTEMAS DE COORDENADAS (SIRGAS 2000) PROJEÇÃO UNIVERSAL TRANSVERSA MERCATOR (UTM) - ZONA - 24M

05 - AS MEDIDAS DE PLANTAS DEVEM SER CONFERIDAS NO LOCAL PARA EVENTUAIS COMPENSAÇÕES

(SIRGAS 2000 - 24M)
Y= 9556663.5812
Y= 9556666.7114
Y= 9556681.6446
Y= 9556687.4041
Y= 9556699.1321
Y= 9556716.4672
Y= 9556733.8212
Y= 9556747.6362
Y= 9556751.2136
Y= 9556769.0114
Y= 9556786.8156
Y= 9556790.7208
Y= 9556805.4847
Y= 9556812.4740
Y= 9556824.5427
Y= 9556837.9570
Y= 9556843.8342
Y= 9556862.7874
Y= 9556879.2649

<p><b>PREFEITURA MUNICIPAL DE ITAIPOCA</b></p>	
<p>PAVIMENTAÇÃO NAS LOCALIDADES DE MACEIÓ, JACARÉ, CÔRREGO DA ESTRADA E APIQUES NO MUNICÍPIO DE ITAIPOCA/CE.</p>	
RODOVIA /APIQUES SETORES 153 A 156	23

Filho  
 ificações  
 E 51462



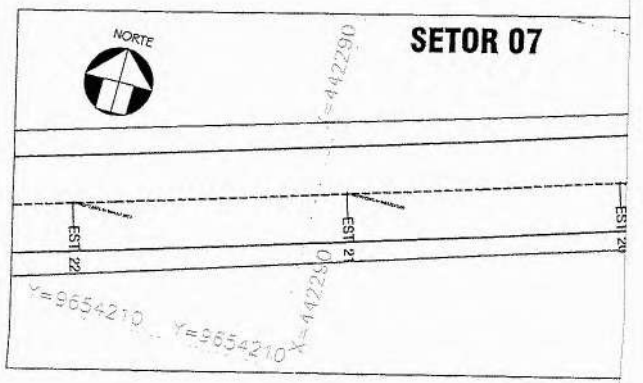
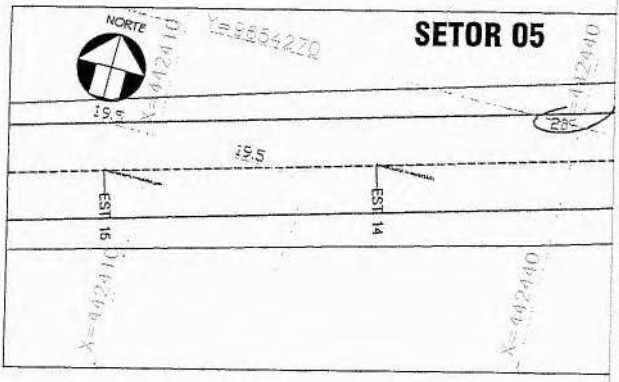
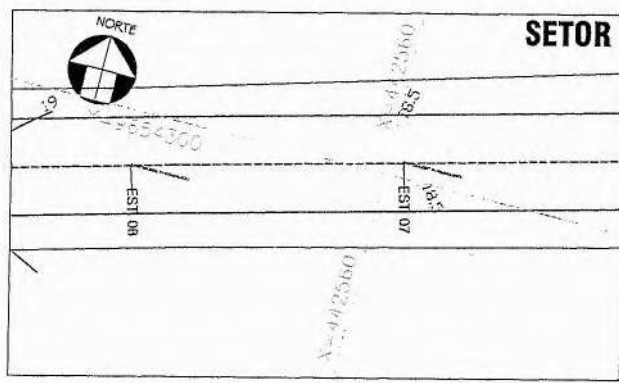
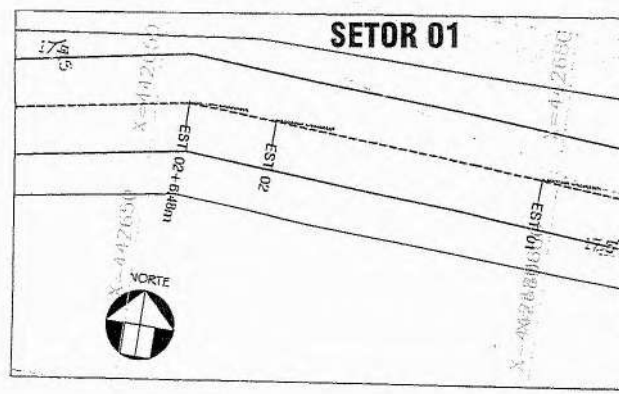

ESTRADA	COORDENADAS (SIRGAS 2000 - 24M)
EST. 01	X= 442678.7637, Y= 9654317.9502
EST. 01	X= 442678.8105, Y= 9654319.3174
EST. 02	X= 442658.6464, Y= 9654320.5227
EST. 02 + 4,00m	X= 442652.3750, Y= 9654320.8978
EST. 02	X= 442639.0554, Y= 9654318.5787
EST. 02 + 12,10m	X= 442627.1354, Y= 9654316.5032
EST. 04	X= 442618.4168, Y= 9654314.8200
EST. 05	X= 442599.8834, Y= 9654310.5402
EST. 06	X= 442580.3822, Y= 9654308.0994
EST. 07	X= 442561.0257, Y= 9654301.0672
EST. 08	X= 442522.3739, Y= 9654290.7871
EST. 09	X= 442522.3739, Y= 9654290.7871
EST. 10	X= 442523.0661, Y= 9654285.5665
EST. 11	X= 442483.7948, Y= 9654280.2318
EST. 12	X= 442464.6324, Y= 9654274.5186
EST. 13	X= 442445.4273, Y= 9654268.9362
EST. 14	X= 442426.1715, Y= 9654263.5371
EST. 15	X= 442406.8885, Y= 9654258.1889
EST. 16	X= 442387.6352, Y= 9654252.8263
EST. 17	X= 442368.5032, Y= 9654246.9874
EST. 18	X= 442349.4481, Y= 9654240.9126
EST. 19	X= 442330.3115, Y= 9654235.0987
EST. 20	X= 442311.1785, Y= 9654229.2647
EST. 21	X= 442292.0207, Y= 9654223.5200
EST. 22	X= 442272.8271, Y= 9654217.9023
EST. 23	X= 442253.6055, Y= 9654212.3652
EST. 24	X= 442234.3849, Y= 9654206.1833
EST. 25	X= 442215.0410, Y= 9654200.3998

SEÇÃO TIPO DAS RUAS  
 7,00

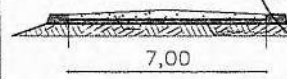

BASE  
 REGULARIZAÇÃO SUBLEITO  
 ESTRADA EXISTENTE

LEGENDAS/NOTAS

- 01 - MEIO FIO PROJETADO
- 02 - EXO DA VIA
- 03 - ESTADUEAMENTO A CADA 20,00m
- 04 - SISTEMAS DE COORDENADAS (SIRGAS 2000) PROJEÇÃO UNIVERSAL TRANSVERSA MERCATOR (UTM) -ZONA - 24M
- 05 - AS MEDIDAS DE PLANTAS DEVEM SER CONFERIDAS NO LOCAL PARA EVENTUAIS COMPENSAÇÕES

**PREFEITURA MUNICIPAL DE ITAIPÓCA**

PAVIMENTAÇÃO NAS LOCALIDADES DE MACEIÓ, JACARÉ, CÔRREGO DA ESTRADA E APIQUES NO NO MUNICÍPIO DE ITAIPÓCA/CE.

ENTRADA APIQUES/CALÇAMENTO INFRAESTRUTURA

SETORES 01 A 08

**24**  
**10**



SEÇÃO TIPO DAS RUAS

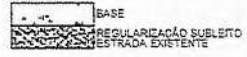
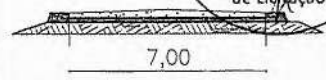

LEGENDAS/NOTAS

- D1 - MEIO FIO PROJETADO
- D2 - EXCO DA VIA
- D3 - ESTAQUEAMENTO A CADA 20.00m
- D4 - SISTEMAS DE COORDENADAS (SRGAS 2000) PROJEÇÃO UNIVERSAL TRANSVERSA MERCATOR (UTM) -ZONA -24d
- D5 - AS MEDIDAS DE PLANTAS DEVEM SER CONFERIDAS NO LOCAL PARA EVENTUAIS COMPENSAÇÕES

ESTACAS	COORDENADAS (SRGAS 2000 - 24d)
EST. 25	X= 442196.3115, Y= 9654394.5738
EST. 27	X= 442177.1950, Y= 9654188.7000
EST. 28	X= 442158.0804, Y= 9654182.8150
EST. 29	X= 442138.8382, Y= 9654177.3560
EST. 29+0.20m	X= 442130.8452, Y= 9654175.1045
EST. 30	X= 442119.6955, Y= 9654171.5585
EST. 31	X= 442100.6111, Y= 9654165.5880
EST. 32	X= 442081.4996, Y= 9654159.6311
EST. 33	X= 442062.4405, Y= 9654153.6319
EST. 34	X= 442043.1977, Y= 9654148.1980
EST. 34+10.00m	X= 442030.1804, Y= 9654144.5018
EST. 35	X= 442024.2581, Y= 9654141.9057
EST. 35+0.20m	X= 442015.7310, Y= 9654138.1660
EST. 35+14.00m	X= 442007.3646, Y= 9654133.9996
EST. 36	X= 442006.1280, Y= 9654133.4958
EST. 37	X= 441987.5421, Y= 9654126.0963
EST. 38	X= 441969.0270, Y= 9654118.5370
EST. 38+10.00m	X= 441958.9671, Y= 9654114.3213
EST. 39	X= 441950.8163, Y= 9654110.2973
EST. 40	X= 441932.6918, Y= 9654101.8430
EST. 41	X= 441914.3349, Y= 9654093.8936
EST. 42	X= 441895.9007, Y= 9654086.1265
EST. 43	X= 441877.4513, Y= 9654078.4009
EST. 44	X= 441858.8001, Y= 9654071.1886
EST. 45	X= 441840.1727, Y= 9654064.4613
EST. 46	X= 441821.5337, Y= 9654056.6732
EST. 47	X= 441802.8389, Y= 9654049.3151
EST. 48	X= 441784.4762, Y= 9654041.6287
EST. 49	X= 441765.8922, Y= 9654034.2495
EST. 49+12.00m	X= 441753.8913, Y= 9654029.4141
EST. 50	X= 441747.4820, Y= 9654026.4537
EST. 51	X= 441729.3698, Y= 9654017.9723
EST. 52	X= 441711.3211, Y= 9654009.3047
EST. 53	X= 441693.2193, Y= 9654000.8405

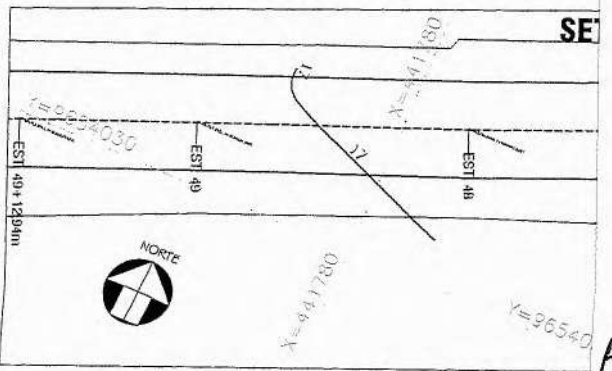
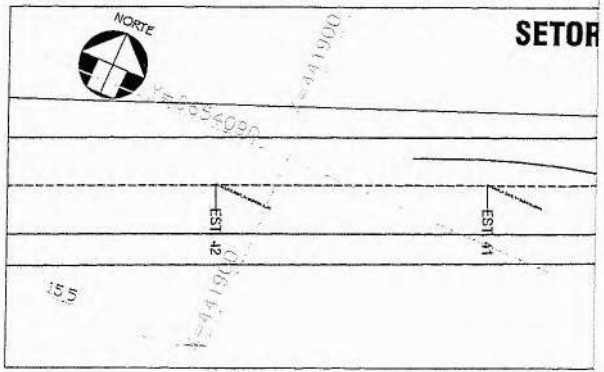
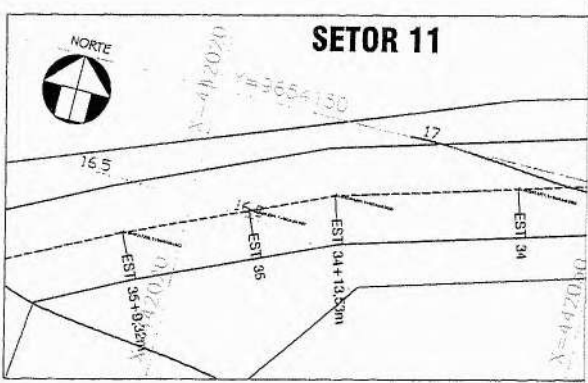
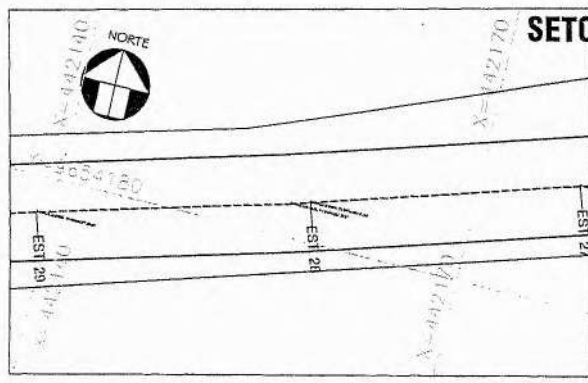

**PREFEITURA MUNICIPAL DE ITAIPOCA**

PAVIMENTAÇÃO NAS LOCALIDADES DE MACEIÓ, JACARÉ, CÓRREGO DA  
ESTRADA E APIQUES NO MUNICÍPIO DE ITAIPOCA/CE.

ENTRADA APIQUES/CALÇAMENTO  
SETORES 09 A 16

INFRAESTRUTURA

25

**Profirio Filho**  
de Obras e Edificações



SEÇÃO TIPO DAS RUAS  
 Comissão Permanente de Licitação

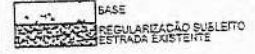
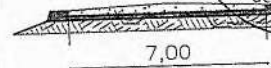

LEGENDAS/NOTAS

- 01 - MEIO FIO PROJETADO
- 02 - EXO DA VIA
- 03 - ESTAQUEAMENTO A CADA 20,00m
- 04 - SISTEMAS DE COORDENADAS (SIRGAS 2000) PROJEÇÃO UNIVERSAL TRANSVERSA MERCATOR (UTM) ZONA - 24M
- 05 - AS MEDIDAS DE PLANTAS DEVEM SER CONFERIDAS NO LOCAL PARA EVENTUAIS COMPENSAÇÕES

ESTACÃO	COORDENADAS (SIRGAS 2000)
EST. 54	X= 441875.2756, Y= 9653992.2175
EST. 55	X= 441956.8884, Y= 9653994.0005
EST. 55+125m	X= 441854.5842, Y= 9653982.5666
EST. 56	X= 441635.2666, Y= 9653974.6023
EST. 57	X= 441623.8251, Y= 9653954.7906
EST. 58	X= 441604.4840, Y= 9653854.8277
EST. 59	X= 441586.8122, Y= 9653945.4839
EST. 60	X= 441569.0527, Y= 9653936.2592
EST. 61	X= 441551.2219, Y= 9653927.1927
EST. 62	X= 441533.2660, Y= 9653918.3949
EST. 62+7,80m	X= 441526.1336, Y= 9653914.0953
EST. 63	X= 441515.6773, Y= 9653908.2697
EST. 64	X= 441497.7479, Y= 9653890.0085
EST. 65	X= 441479.9247, Y= 9653890.0436
EST. 66	X= 441462.2588, Y= 9653881.9541
EST. 67	X= 441444.6653, Y= 9653872.4551
EST. 68	X= 441426.8834, Y= 9653863.3096
EST. 68+10,80m	X= 441417.0021, Y= 9653858.4250
EST. 69	X= 441408.3206, Y= 9653854.0979
EST. 69+14,80m	X= 441394.2150, Y= 9653846.2124
EST. 70	X= 441391.1907, Y= 9653844.8693
EST. 71	X= 441372.8547, Y= 9653836.8904
EST. 71+12,70m	X= 441360.8914, Y= 9653831.8801
EST. 72	X= 441354.7160, Y= 9653828.5206
EST. 73	X= 441337.3862, Y= 9653818.8995
EST. 74	X= 441319.6880, Y= 9653809.2056
EST. 75	X= 441302.0684, Y= 9653799.7416
EST. 76	X= 441284.3452, Y= 9653790.4738
EST. 77	X= 441266.7031, Y= 9653781.0604
EST. 78	X= 441249.1307, Y= 9653772.5136
EST. 79	X= 441231.5471, Y= 9653763.9924
EST. 80	X= 441213.8354, Y= 9653752.4938

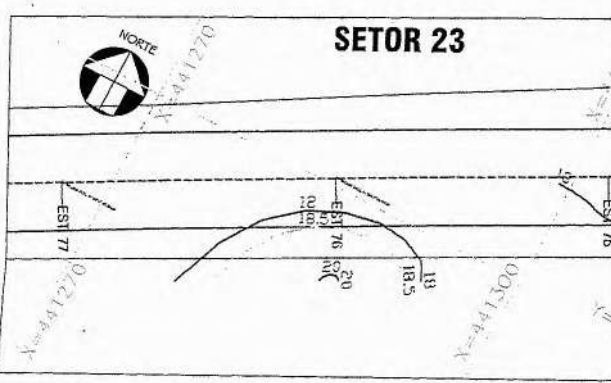
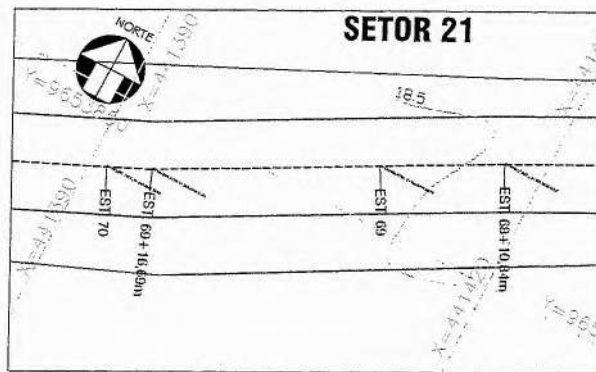
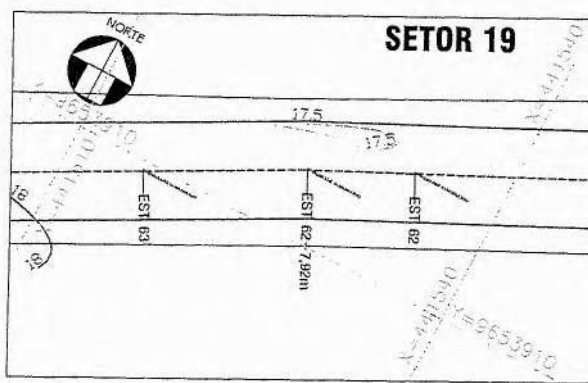
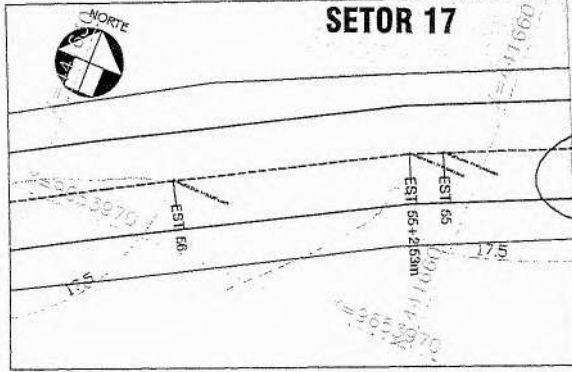

**PREFEITURA MUNICIPAL DE ITAIPOCA**

PAVIMENTAÇÃO NAS LOCALIDADES DE MACEIÓ, JACARÉ, CARRÉGO DA ESTRADA E APIQUES NO MUNICÍPIO DE ITAIPOCA/CE.

ENTRADA APIQUES/CALÇAMENTO	INFRAESTRUTURA	<b>26</b>
SETORES 17 A 24		<b>40</b>

Filho

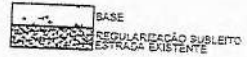
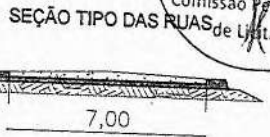

LEGENDAS/NOTAS

- D1 - MEIO FIO PROJETADO
- D2 - EIXO DA VIA
- D3 - ESTAOEAMENTO A CADA 20,00m
- D4 - SISTEMAS DE COORDENADAS (SIRGAS 2000) PROJEÇÃO UNIVERSAL TRANSVERSA MERCATOR (UTM) ZONA - 24M
- D5 - AS MEDIDAS DE PLANTAS DEVEM SER CONFERIDAS NO LOCAL PARA EVENTUAIS COMPENSAÇÕES

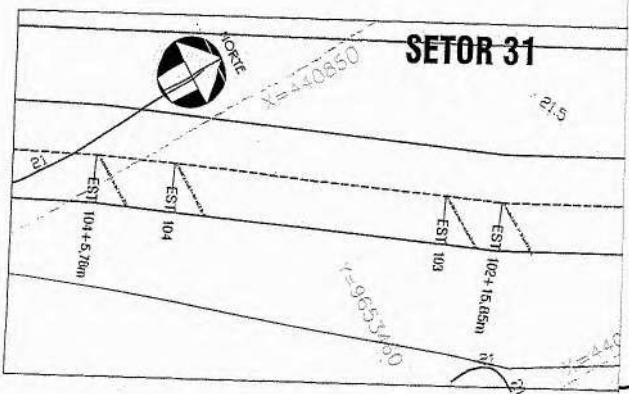
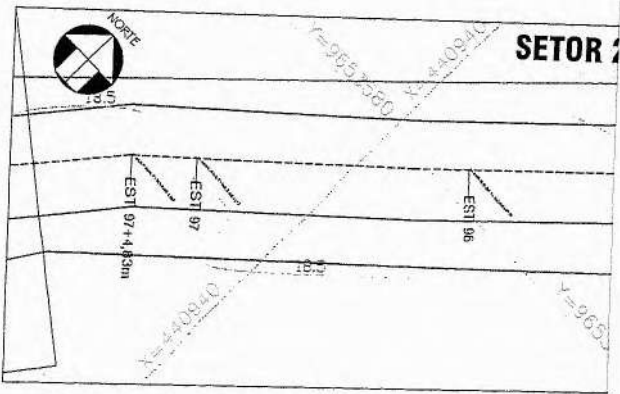
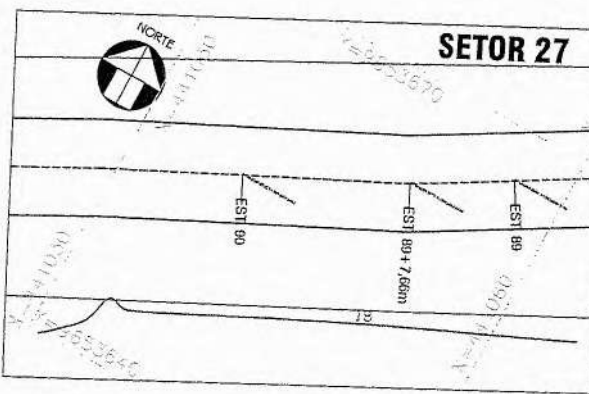
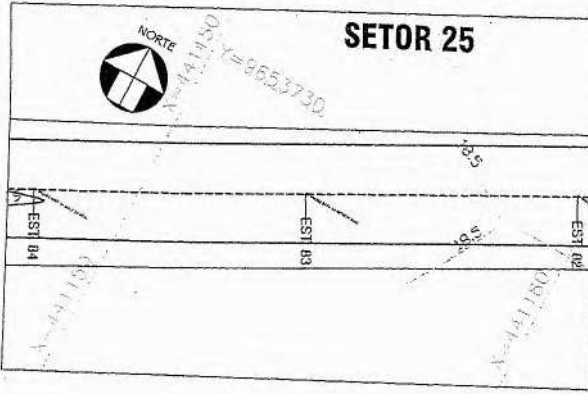

ESTRADA	COORDENADAS (SIRGAS 2000 - UTM)
EST. 01	X= 441196.1274, Y= 9653743.3972
EST. 02	X= 441178.4512, Y= 9653734.0350
EST. 03	X= 441160.8470, Y= 9653724.5519
EST. 04	X= 441143.1647, Y= 9653715.2030
EST. 05	X= 441125.4026, Y= 9653705.9140
EST. 06	X= 441107.7002, Y= 9653696.7113
EST. 07	X= 441090.0898, Y= 9653687.2310
EST. 07+3,00m	X= 441087.3935, Y= 9653685.7789
EST. 08	X= 441073.1959, Y= 9653676.5388
EST. 09	X= 441056.0268, Y= 9653666.3145
EST. 09+7,00m	X= 441049.3979, Y= 9653662.6498
EST. 10	X= 441038.3038, Y= 9653657.0465
EST. 11	X= 441020.4814, Y= 9653647.5975
EST. 11+10,70m	X= 441015.6570, Y= 9653640.1083
EST. 12	X= 441003.3326, Y= 9653637.8946
EST. 13	X= 440988.8213, Y= 9653634.1299
EST. 13+12,70m	X= 440975.8191, Y= 9653632.0714
EST. 14	X= 440974.2385, Y= 9653630.4610
EST. 15	X= 440960.3165, Y= 9653626.0785
EST. 16	X= 440946.0398, Y= 9653621.0926
EST. 17	X= 440927.8886, Y= 9653615.1297
EST. 17+8,00m	X= 440927.8886, Y= 9653615.1297
EST. 18	X= 440918.9215, Y= 9653613.3500
EST. 19	X= 440906.0681, Y= 9653611.2513
EST. 19+10,00m	X= 440899.7016, Y= 9653610.1642
EST. 199	X= 440894.6725, Y= 9653611.1635
EST. 201	X= 440884.2835, Y= 9653604.0924
EST. 202	X= 440874.1443, Y= 9653606.8389
EST. 202+15,00m	X= 440865.8491, Y= 9653613.3071
EST. 203	X= 440863.3788, Y= 9653619.9724
EST. 204	X= 440851.4735, Y= 9653615.9018
EST. 204+6,70m	X= 440848.0312, Y= 9653619.2551
EST. 205	X= 440840.2434, Y= 9653617.3573
EST. 206	X= 440829.2482, Y= 9653610.6492
EST. 207	X= 440818.0635, Y= 9653604.0094
EST. 207+1,00m	X= 440817.3820, Y= 9653603.0464
EST. 207+14,20m	X= 440814.2492, Y= 9653600.5081
EST. 208	X= 440814.7945, Y= 9653604.8851

**PREFEITURA MUNICIPAL DE ITAIPÓICA**  
 PAVIMENTAÇÃO NAS LOCALIDADES DE MACEIÓ, JACARÉ, CÔRREGO DA  
 ESTRADA E APIQUES NO MUNICÍPIO DE ITAIPÓICA/CE.  
 ENTRADA APIQUES/CALÇAMENTO  
 INFRAESTRUTURA  
 SETORES 25 A 32

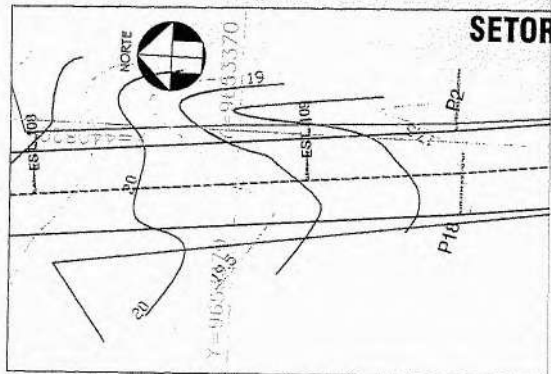

ESTADA	COORDENADAS SIRGAS 2000 - 24M
EST. 103	X= 440216.7549, Y= 9653364.7817
EST. 110	X= 440218.8836, Y= 9653346.8825
EST. 109+11.00m	X= 440220.3651, Y= 9653332.0258
EST. 117	X= 440220.5761, Y= 9653374.9888
EST. 112	X= 440221.2923, Y= 9653305.0032
EST. 113	X= 440222.2638, Y= 9653285.0257
EST. 114	X= 440223.1803, Y= 9653265.0479
EST. 114+12.00m	X= 440223.9300, Y= 9653252.2375
EST. 115	X= 440224.7149, Y= 9653245.3106
EST. 114+12.00m	X= 440226.0619, Y= 9653232.8802
EST. 115+12.00m	X= 440220.6035, Y= 9653231.0152
EST. 116	X= 440216.6836, Y= 9653230.7497
EST. 114+16.10m	X= 440208.6247, Y= 9653229.2084
EST. 117	X= 440798.8082, Y= 9653228.9481
EST. 117+4.00m	X= 440790.1937, Y= 9653228.7197

SEÇÃO TIPO DAS RUAS

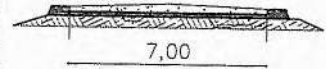

LEGENDAS/NOTAS

- D1 - MEIO FIO PROJETADO \_\_\_\_\_
- D2 - EIXO DA VIA \_\_\_\_\_

D3 - ESTAQUEAMENTO A CADA 20,00m

D4 - SISTEMAS DE COORDENADAS (SIRGAS 2000) PROJEÇÃO UNIVERSAL TRANSVERSA MERCATOR (UTM) - ZONA - 24M

D5 - AS MEDIDAS DE PLANTAS DEVEM SER CONFERIDAS NO LOCAL PARA EVENTUAIS COMPENSAÇÕES

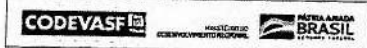
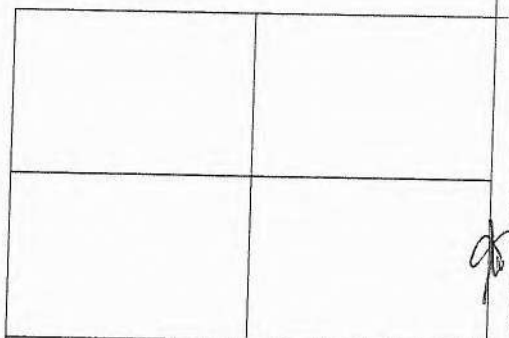

PREFEITURA MUNICIPAL DE ITAIPICOLA

PAVIMENTAÇÃO NAS LOCALIDADES DE MACEIÓ, JACARÉ, CÔRREGO DA ESTRADA E APIQUES NO MUNICÍPIO DE ITAIPICOLA/CE.

ENTRADA APIQUES/CALÇAMENTO  
 SETORES 33 A 35

INFRAESTRUTURA

SEÇÃO TIPO DAS RUAS

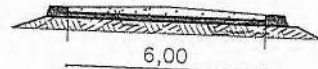

LEGENDAS/NOTAS

- 01 - MEIO FIO PROJETADO \_\_\_\_\_
- 02 - EIXO DA VIA \_\_\_\_\_
- 03 - ESTAQUEAMENTO A CADA 20,00m
- 04 - SISTEMAS DE COORDENADAS (SIRGAS 2000) PROJEÇÃO UNIVERSAL TRANSVERSA MERCATOR (UTM) - ZONA - 24M
- 05 - AS MEDIDAS DE PLANTAS DEVEM SER CONFERIDAS NO LOCAL PARA EVENTUAIS COMPENSAÇÕES

ESTADAS	COORDENADAS SIRGAS 2000 - 24M
L. 00	X= 442006,8564, Y= 9654130,0069
L. 00= 16,51m	X= 442005,8709, Y= 9654115,8171
L. 01	X= 442004,2566, Y= 9654109,2520
L. 02	X= 442001,3092, Y= 9654089,4669
L. 03	X= 441998,7829, Y= 9654069,6328
L. 03= 5,63m	X= 441998,1739, Y= 9654064,6417
L. 04	X= 441995,9157, Y= 9654049,7267
L. 05	X= 441995,1123, Y= 9654029,8018
L. 06	X= 441991,2476, Y= 9654009,8891
L. 07	X= 441991,6744, Y= 9653989,9537
L. 08	X= 441989,7115, Y= 9653970,0409
L. 08= 11,17m	X= 441988,7906, Y= 9653958,9620
L. 09	X= 441988,5582, Y= 9653950,0850
L. 10	X= 441988,0949, Y= 9653930,0919
L. 10= 1,46m	X= 441987,8967, Y= 9653928,6302

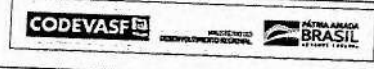
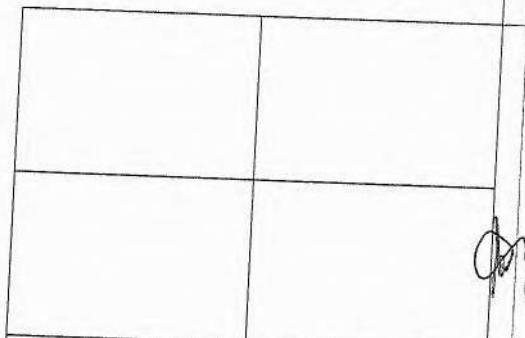

PREFEITURA DE Itaipicola  
 PREFEITURA MUNICIPAL DE ITAIPICOLA

PAVIMENTAÇÃO NAS LOCALIDADES DE MADEIÓ, JACARÉ, CÔRREGO DA ESTRADA E APIQUES NO MUNICÍPIO DE ITAIPICOLA/CE.

ENTRADA APIQUES/CALÇAMENTO INFRAESTRUTURA

ESCOLA

29

Filho e Edificações DE 81422